

STANDARD LAYER REPORT		
	AREA	QTY
Building Services	44	1
Circulation	1,069	4
Mechanical Space	4,912	9
Net Assignable Space	19,851	10
Vertical Penetrations	680	4
TOTAL:	26,556	28
Floor Gross:	28,393	

STANDARD SPACE REPORT

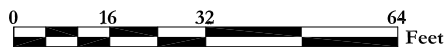

SCIENCE RESEARCH AND TEACHING CENTER

Sub-Basement Floor Plan B3

1719 SW 10th, Portland, Oregon 97201

Print Date:





Last Modified Date: 03/2016

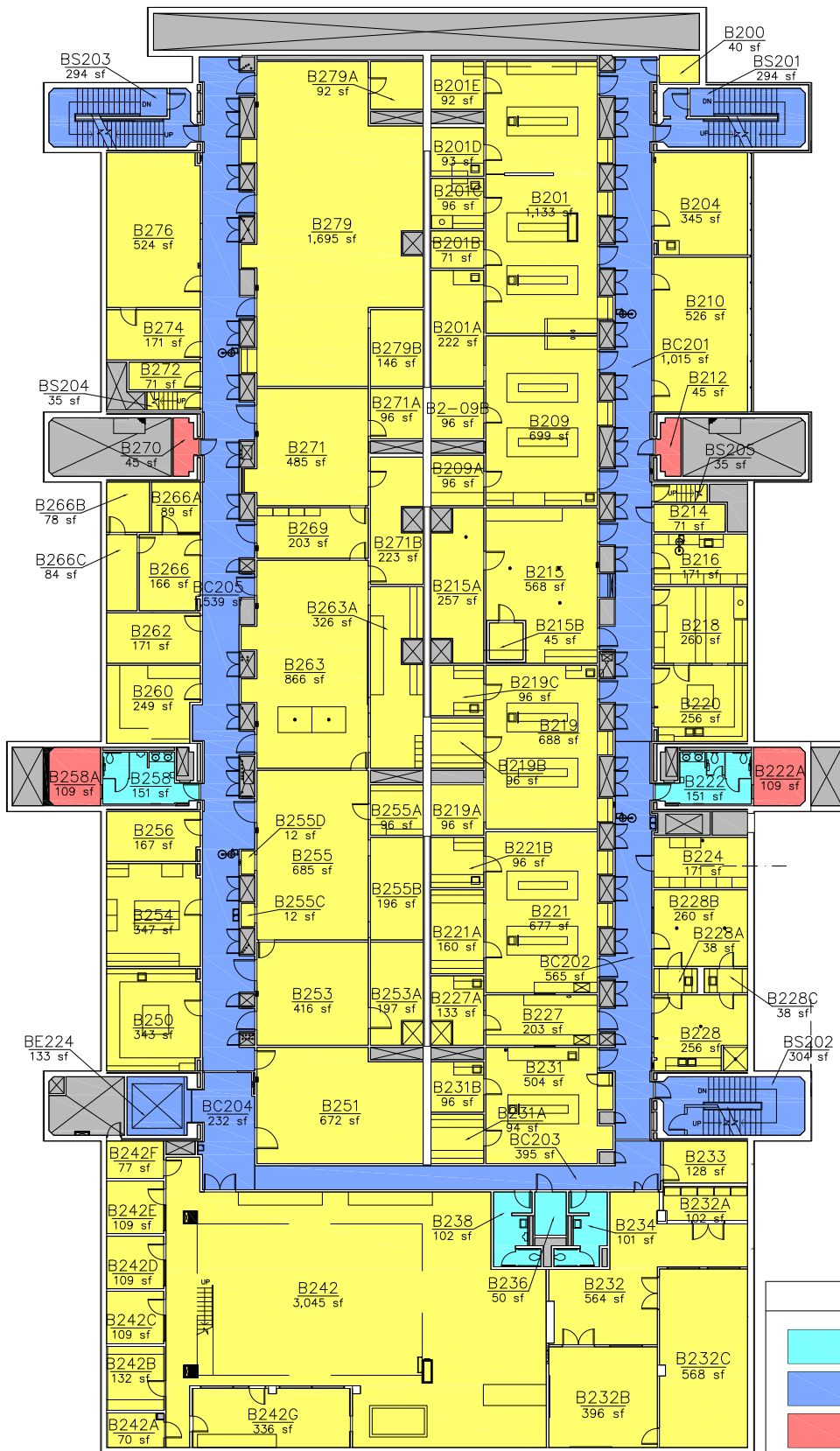

Campus Planning Office

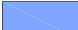
<http://www.pdx.edu/planning-sustainability>



STANDARD LAYER REPORT			
		AREA	QTY
	Building Services	555	5
	Circulation	4,771	9
	Mechanical Space	308	4
	Net Assignable Space	23,532	80
	Vertical Penetrations	2,777	112
TOTAL:		31,943	210
Floor Gross:		35,281	

STANDARD SPACE REPORT

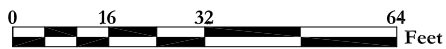

SCIENCE RESEARCH AND TEACHING CENTER

Basement Floor Plan B2

1719 SW 10th, Portland, Oregon 97201

Print Date:

Last Modified Date: 03/2016



Campus Planning Office
<http://www.pdx.edu/planning-sustainability>

STANDARD LAYER REPORT

	AREA	QTY
Building Services	817	10
Circulation	6,506	19
Mechanical Space	239	3
Net Assignable Space	21,200	77
Open To Below	1,294	1
Vertical Penetrations	2,713	95
TOTAL:	32,769	205
Floor Gross:	34,970	

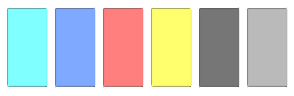
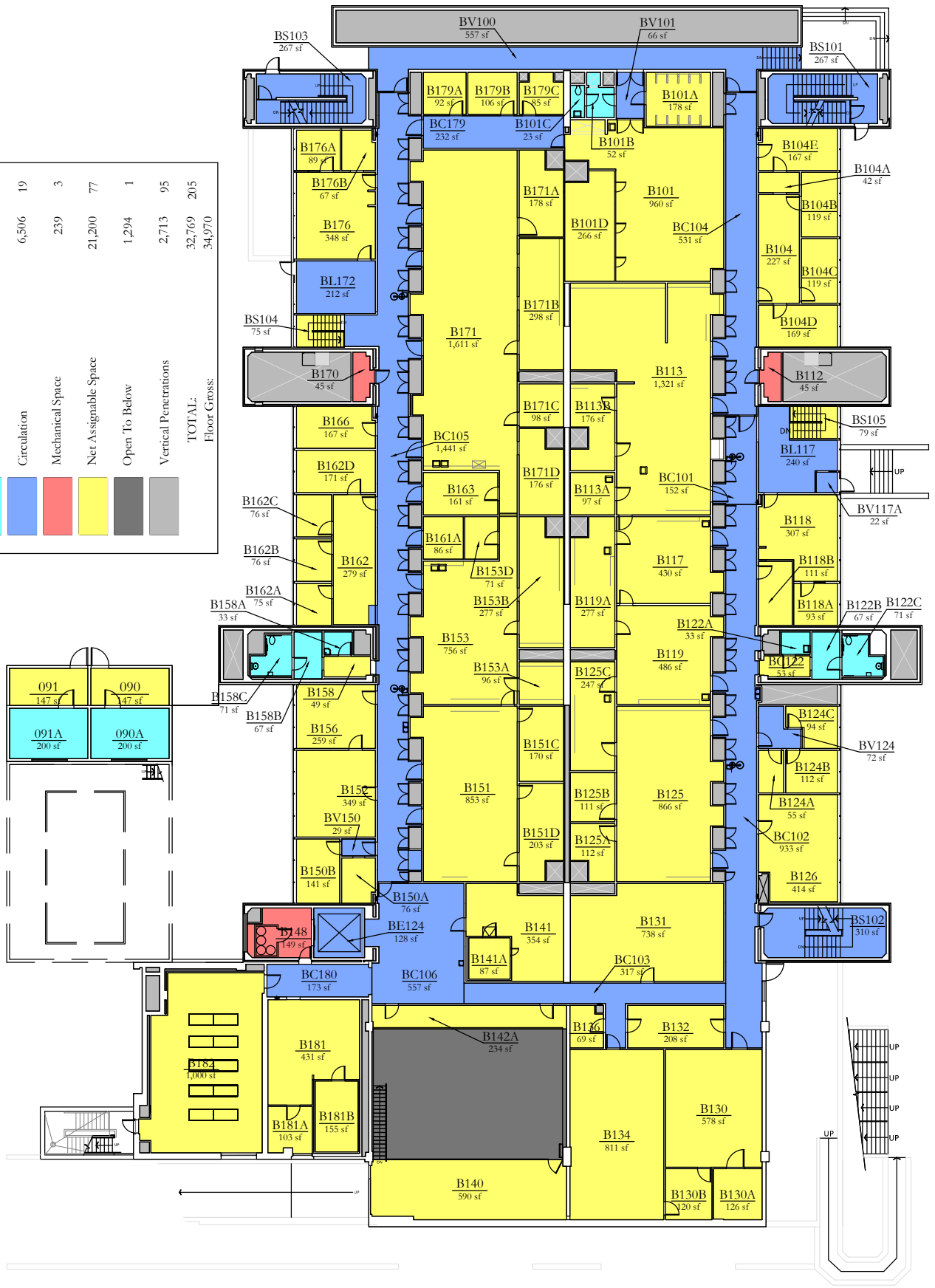
STANDARD SPACE REPORT

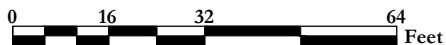

SCIENCE RESEARCH AND TEACHING CENTER

Basement Floor Plan B1





1719 SW 10th, Portland, Oregon 97201

Print Date:

Last Modified Date: 04/2019



Campus Planning Office
<http://www.pdx.edu/planning-sustainability>

STANDARD LAYER REPORT			
	AREA	QTY	
	Building Services	546	4
	Circulation	6,295	12
	Mechanical Space	93	2
	Net Assignable Space	25,321	60
	Vertical Penetrations	890	27
TOTAL:		33,145	105
Floor Gross:		35,991	



STANDARD SPACE REPORT

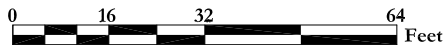

SCIENCE RESEARCH AND TEACHING CENTER

First Floor Plan

1719 SW 10th, Portland, Oregon 97201

Print Date:

Last Modified Date: 03/2016







Campus Planning Office

<http://www.pdx.edu/planning-sustainability>

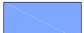

STANDARD LAYER REPORT

	AREA	QTY
	Building Services	910 5
	Circulation	5,927 14
	Mechanical Space	44 2
	Net Assignable Space	25,038 58
	Vertical Penetrations	1,330 41
TOTAL:		33,249 120
Floor Gross:		36,203

STANDARD SPACE REPORT

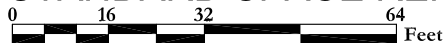

SCIENCE RESEARCH AND TEACHING CENTER

Second Floor Plan

1719 SW 10th, Portland, Oregon 97201





Print Date:

Last Modified Date: 06/2023

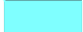
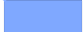

Campus Planning Office

<http://www.pdx.edu/planning-sustainability>

STANDARD LAYER REPORT		
	AREA	QTY
	Building Services	330 3
	Circulation	5,676 8
	Mechanical Space	138 4
	Net Assignable Space	16,639 44
	Vertical Penetrations	1,211 30
TOTAL:		23,994 89
Floor Gross:		26,130



STANDARD SPACE REPORT

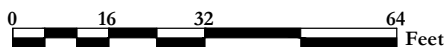

SCIENCE RESEARCH AND TEACHING CENTER

Third Floor Plan

1719 SW 10th, Portland, Oregon 97201

Print Date:

Last Modified Date: 10/2018



Campus Planning Office

<http://www.pdx.edu/planning-sustainability>

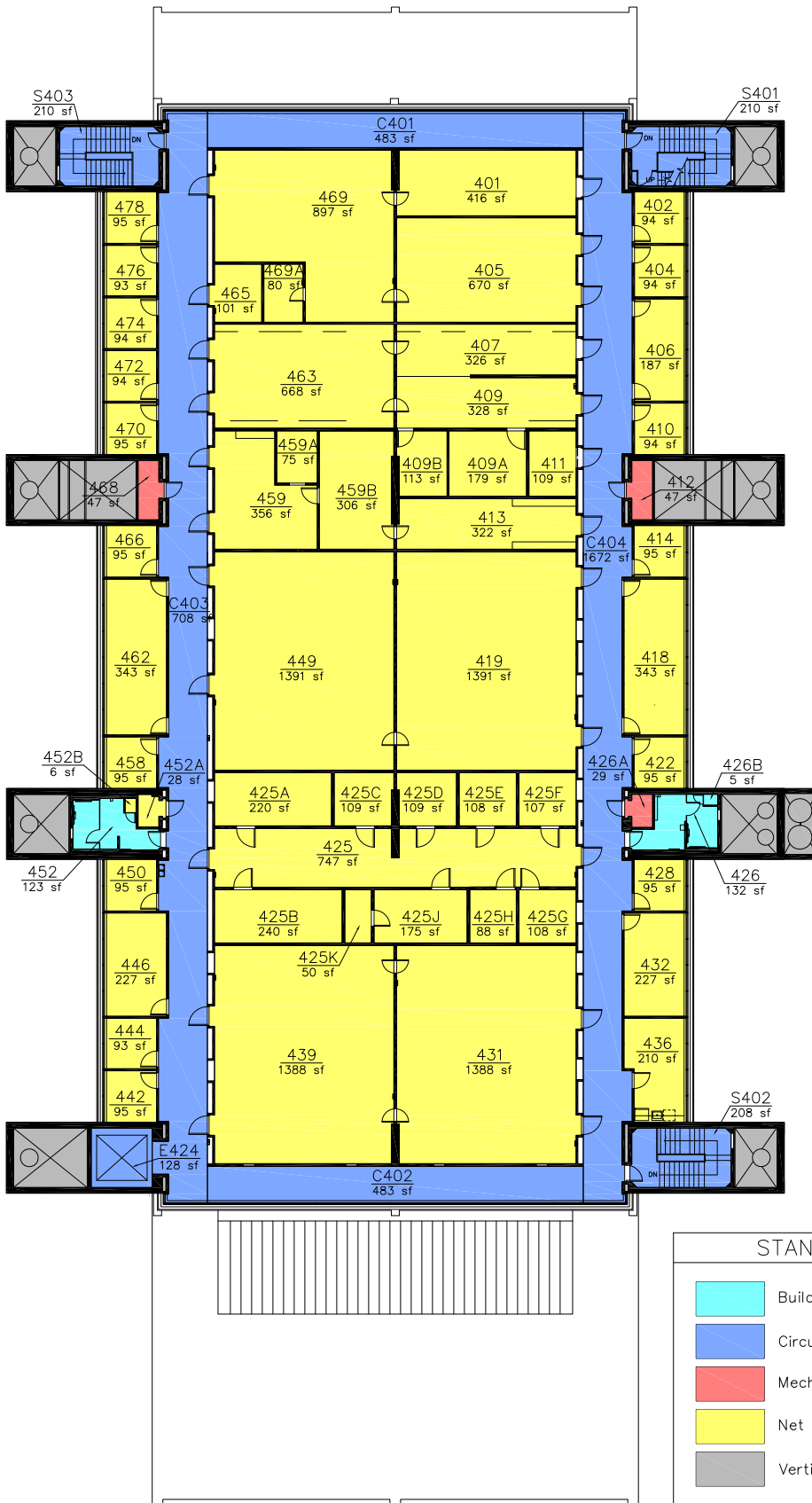

STANDARD SPACE REPORT

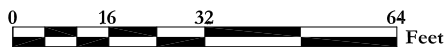

SCIENCE RESEARCH AND TEACHING CENTER

Fourth Floor Plan

1719 SW 10th, Portland, Oregon 97201

Print Date:

Last Modified Date: 03/2016



Campus Planning Office

<http://www.pdx.edu/planning-sustainability>

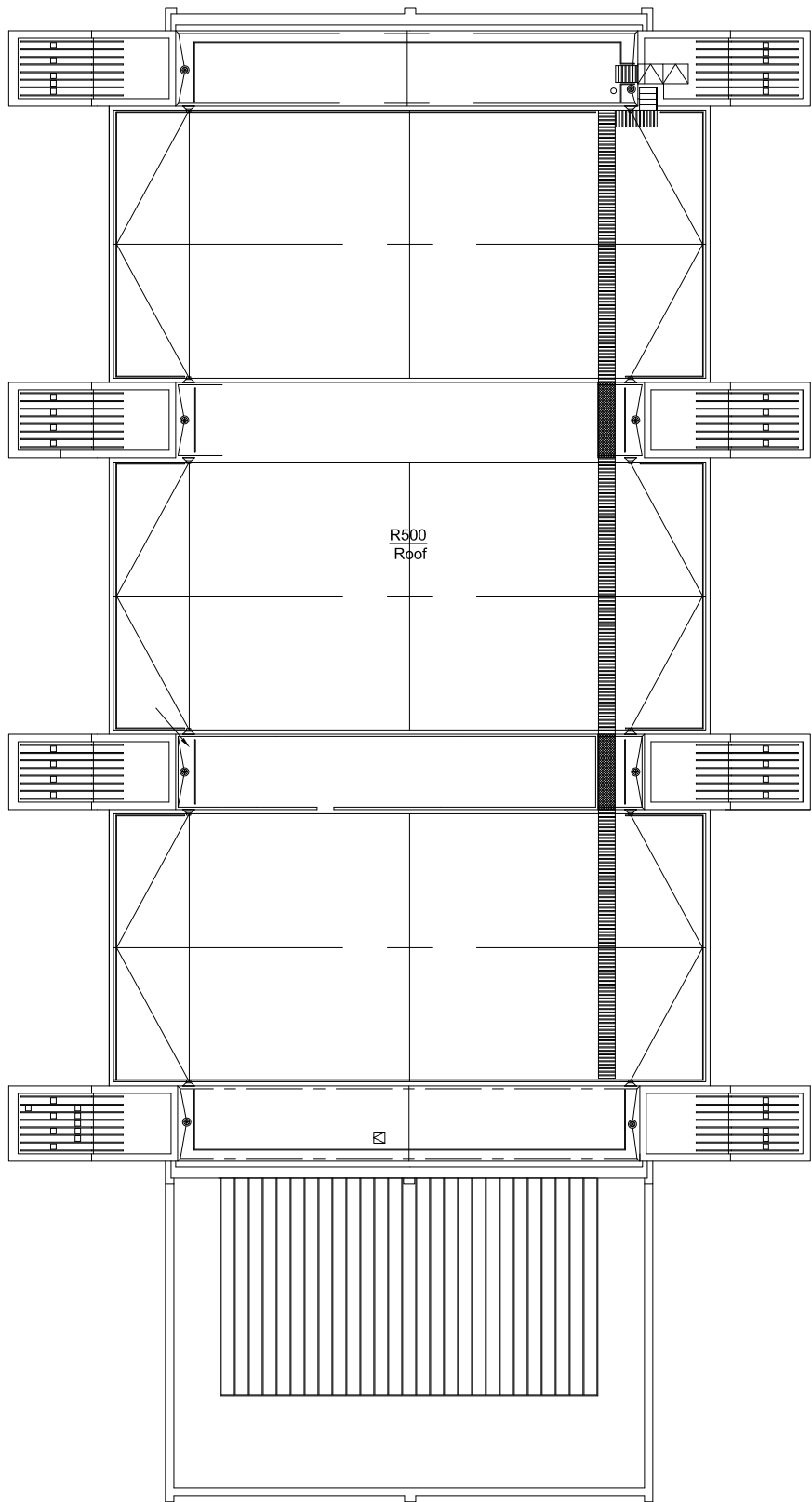

STANDARD SPACE REPORT

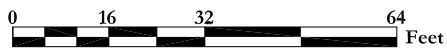

SCIENCE RESEARCH AND TEACHING CENTER

Roof Plan

1719 SW 10th, Portland, Oregon 97201

Print Date:

Last Modified Date: 03/2016



Campus Planning Office

<http://www.pdx.edu/planning-sustainability>