

# STANDARD SPACE REPORT

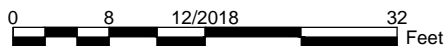

SAINT HELENS  
First Floor Plan

1131 SW Montgomery Street, Portland, Oregon 97201-3260

Print Date:





Last Modified Date: 01/2019

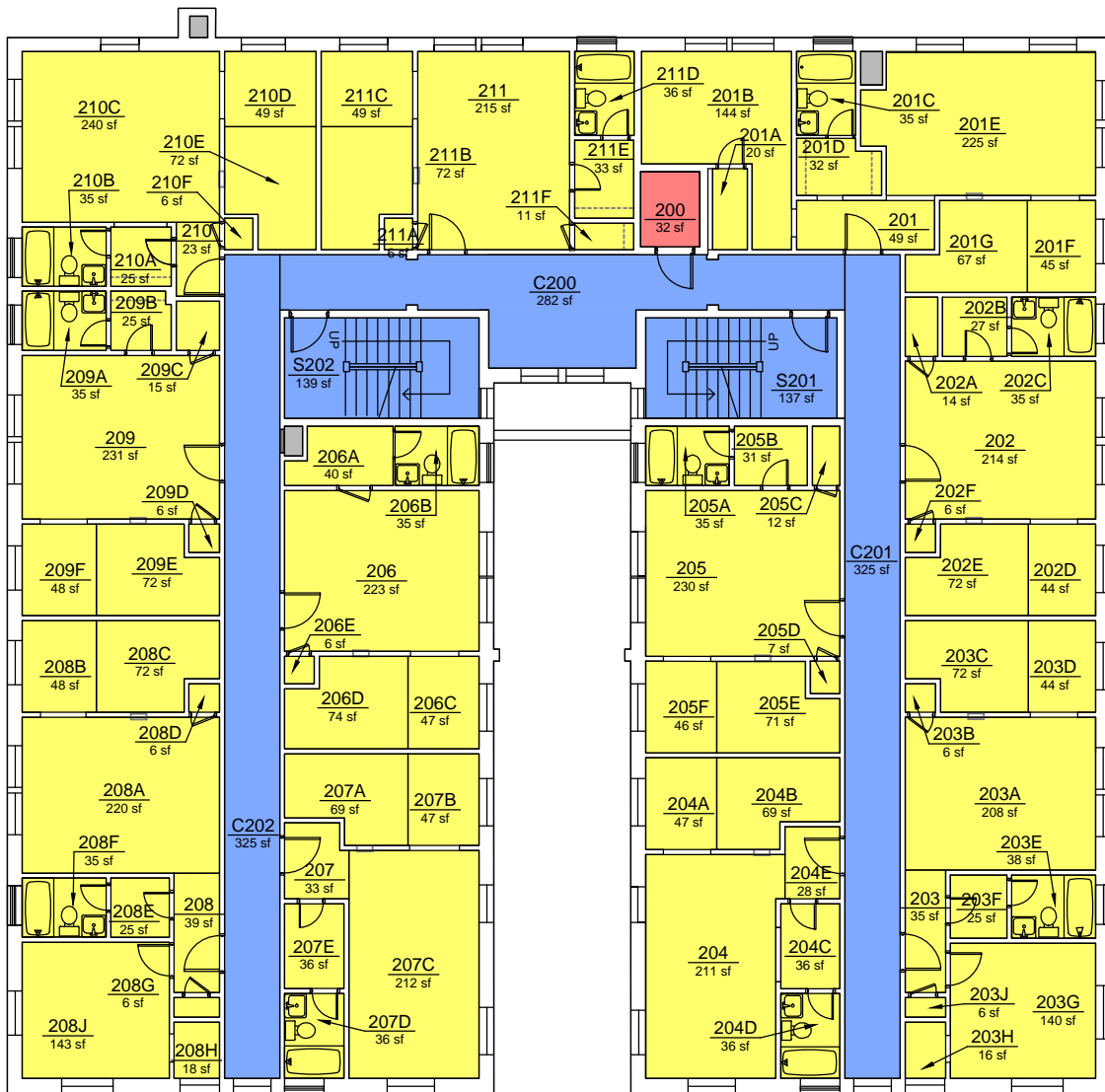

Campus Planning Office  
<http://www.pdx.edu/planning-sustainability>



### STANDARD LAYER REPORT

	AREA	QTY
 Circulation	1,208	5
 Mechanical Space	32	1
 Net Assignable Space	5,252	81
 Vertical Penetrations	12	3
TOTAL:	6,504	90
Floor Gross:	7,621	

### STANDARD SPACE REPORT

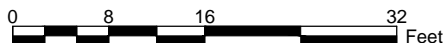

SAINT HELENS  
Second Floor Plan

1131 SW Montgomery Street, Portland, Oregon 97201-3260

Print Date:

Last Modified Date: 01/2019





Campus Planning Office

<http://www.pdx.edu/planning-sustainability>

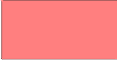

### STANDARD LAYER REPORT

	AREA	QTY
 Circulation	1,208	5
 Mechanical Space	32	1
 Net Assignable Space	5,252	81
 Vertical Penetrations	12	3
<b>TOTAL:</b>	<b>6,504</b>	<b>90</b>
<b>Floor Gross:</b>	<b>7,621</b>	

### STANDARD SPACE REPORT

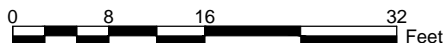

SAINT HELENS  
Third Floor Plan

1131 SW Montgomery Street, Portland, Oregon 97201-3260

Print Date:

Last Modified Date: 01/2019







Campus Planning Office

<http://www.pdx.edu/planning-sustainability>



### STANDARD LAYER REPORT

	AREA	QTY
 Circulation	1,208	5
 Mechanical Space	32	1
 Net Assignable Space	5,252	81
 Vertical Penetrations	12	3
<b>TOTAL:</b>	<b>6,504</b>	<b>90</b>
<b>Floor Gross:</b>	<b>7,621</b>	



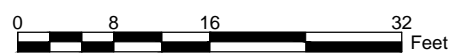

### STANDARD SPACE REPORT

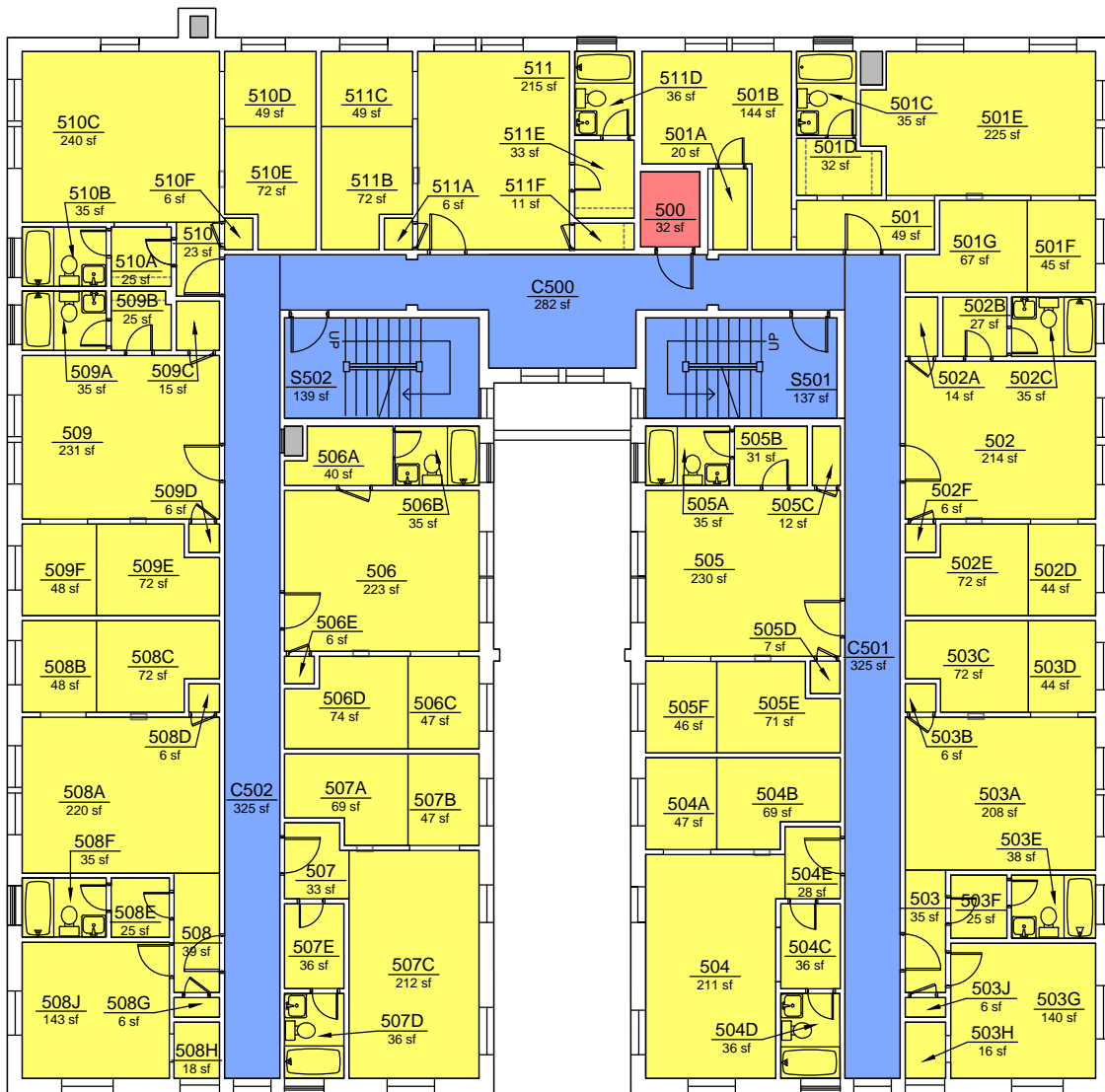

**SAINT HELENS**  
**Fourth Floor Plan**  
 1131 SW Montgomery Street, Portland, Oregon 97201-3260  
 Print Date:  
 Last Modified Date: 01/2019

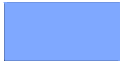

### STANDARD LAYER REPORT

	AREA	QTY
 Circulation	1,208	5
 Mechanical Space	32	1
 Net Assignable Space	5,252	81
 Vertical Penetrations	12	3
<b>TOTAL:</b>	<b>6,504</b>	<b>90</b>
Floor Gross:	7,621	

### STANDARD SPACE REPORT

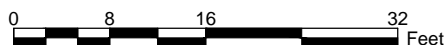

SAINT HELENS  
Fifth Floor Plan

1131 SW Montgomery Street, Portland, Oregon 97201-3260

Print Date:

Last Modified Date: 01/2018



Campus Planning Office

<http://www.pdx.edu/planning-sustainability>

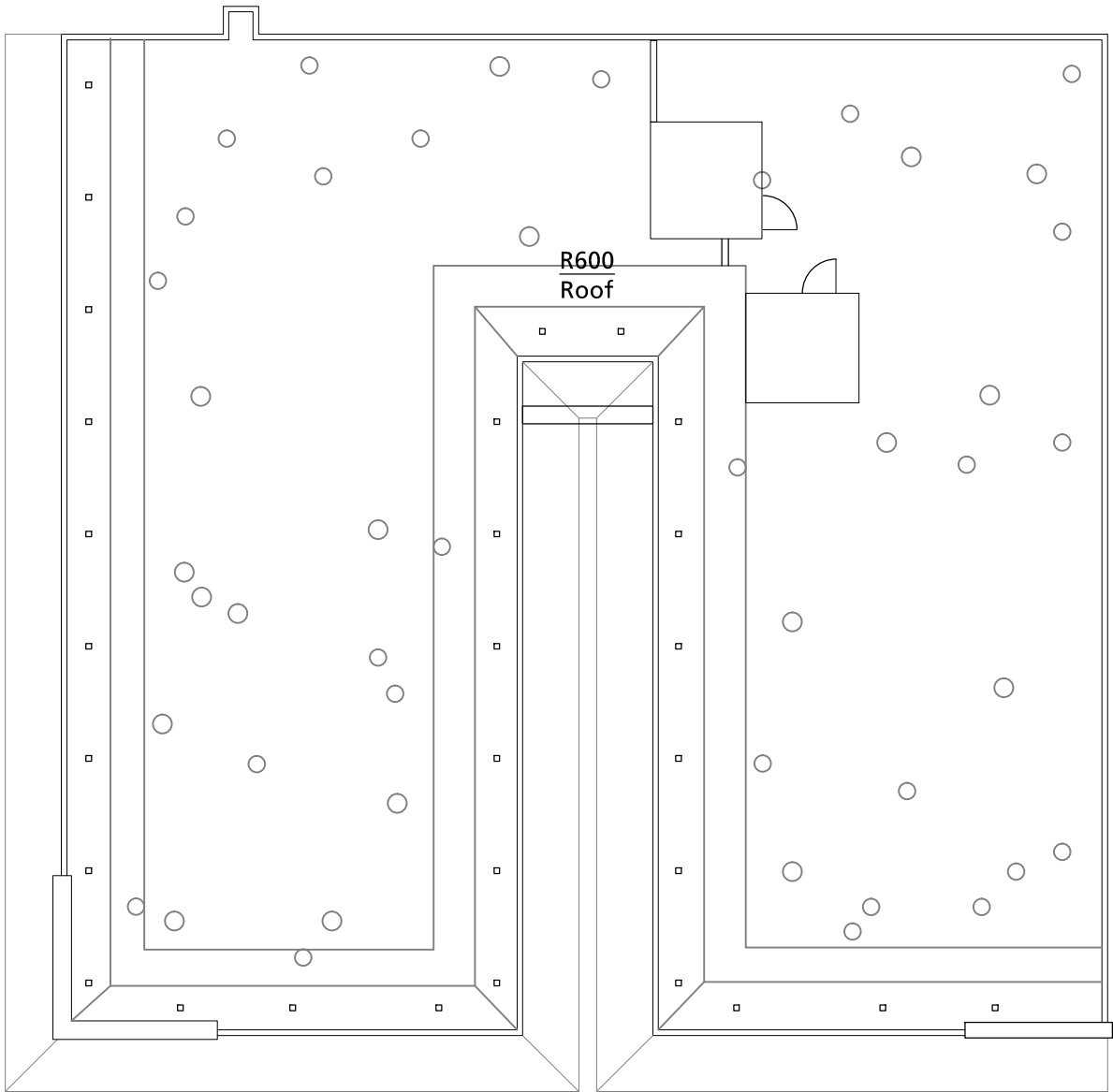

**BASE FLOOR PLAN**



**SAINT HELENS  
Roof Plan**

1131 SW Montgomery Street, Portland, Oregon 97201-3260  
 Print Date: 10/2010  
 Last Modified Date: 10/2010



Campus Planning Office  
<http://www.pdx.edu/planning-sustainability>