





STANDARD LAYER REPORT		
	AREA	QTY
 Circulation	541	5
 Mechanical Space	333	6
 Net Assignable Space	33231	2
 Vertical Penetrations	14552	1
TOTAL:	48657	14
Floor Gross:	50337	

STANDARD SPACE REPORT

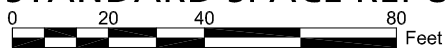

PARKING STRUCTURE THREE Basement Floor Plan

1631 SW Twelfth Avenue, Portland, Oregon 97201

Print Date:

Last Modified Date: 2/2013





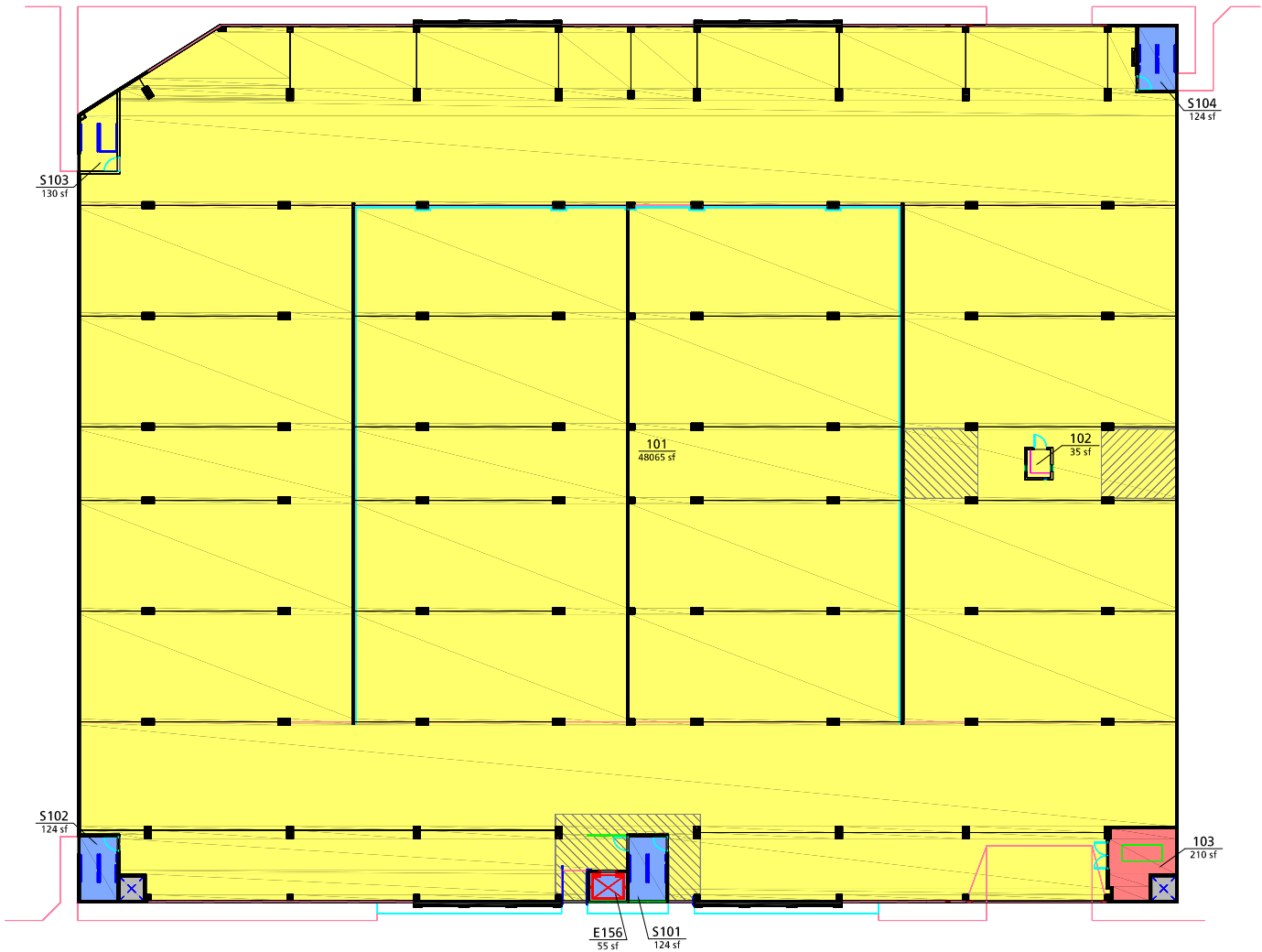

Portland State
UNIVERSITY

Capital Projects and Construction
<http://www.pdx.edu/construction>



STANDARD LAYER REPORT

	AREA	QTY
 Building Services	35	1
 Circulation	557	5
 Mechanical Space	210	1
 Net Assignable Space	48,065	1
 Vertical Penetrations	60	2
TOTAL:	48,927	10
Floor Gross:	49,877	

STANDARD SPACE REPORT

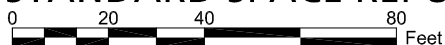

PARKING STRUCTURE THREE First Floor Plan

1631 SW Twelfth Avenue, Portland, Oregon 97201

Print Date: 10/2010

Last Modified Date: 10/2010





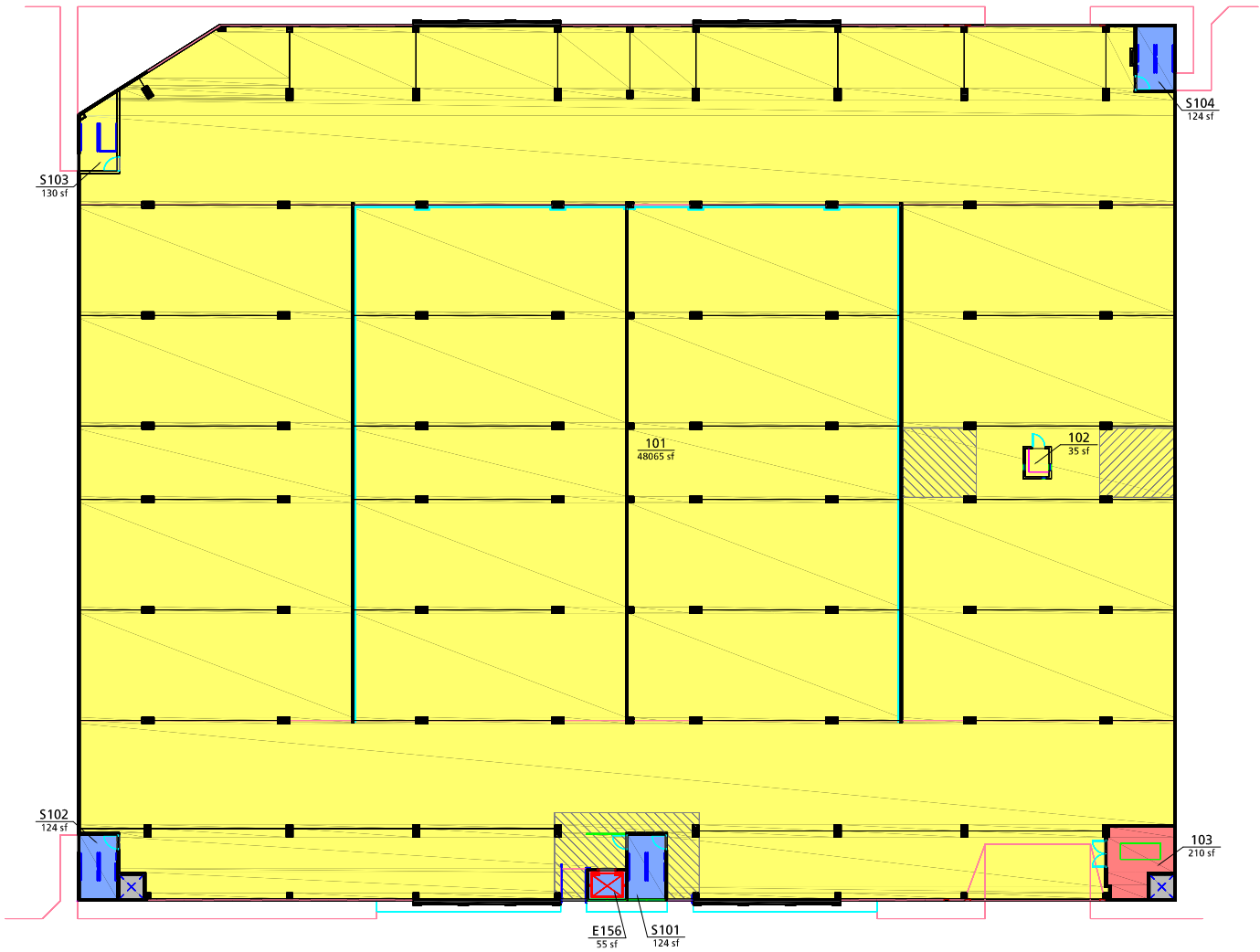

Portland State
UNIVERSITY

Capital Projects and Construction
<http://www.pdx.edu/construction>



STANDARD LAYER REPORT

	AREA	QTY
 Building Services	35	1
 Circulation	557	5
 Mechanical Space	210	1
 Net Assignable Space	48,065	1
 Vertical Penetrations	60	2
TOTAL:	48,927	10
Floor Gross:	49,877	

STANDARD SPACE REPORT

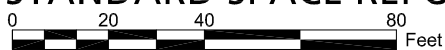

PARKING STRUCTURE THREE First Floor Plan

1631 SW Twelfth Avenue, Portland, Oregon 97201

Print Date: 10/2010



Last Modified Date: 10/2010

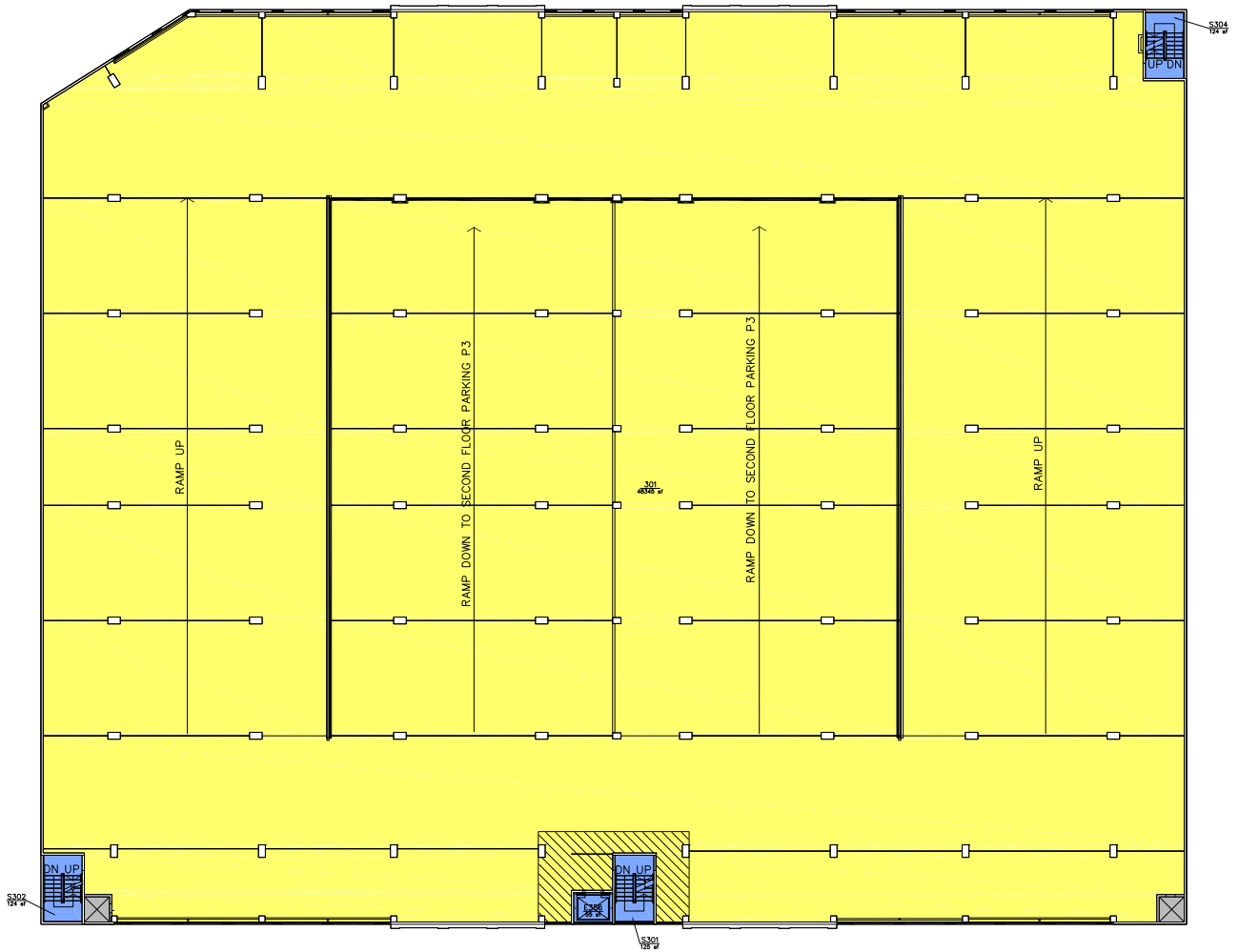

Portland State
UNIVERSITY

Capital Projects and Construction
<http://www.pdx.edu/construction>



STANDARD LAYER REPORT					
	Circulation	AREA	428	QTY	4
	Net Assignable Space	48,345	1		
	Vertical Penetrations	60	2		
TOTAL:		48,833	7		
Floor Gross:		49,877			

STANDARD SPACE REPORT

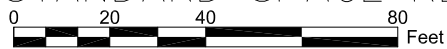

PARKING STRUCTURE THREE

Third Floor Plan

1631 SW Twelfth Avenue, Portland, Oregon 97201

Print Date: 10/2010



Last Modified Date: 10/2010

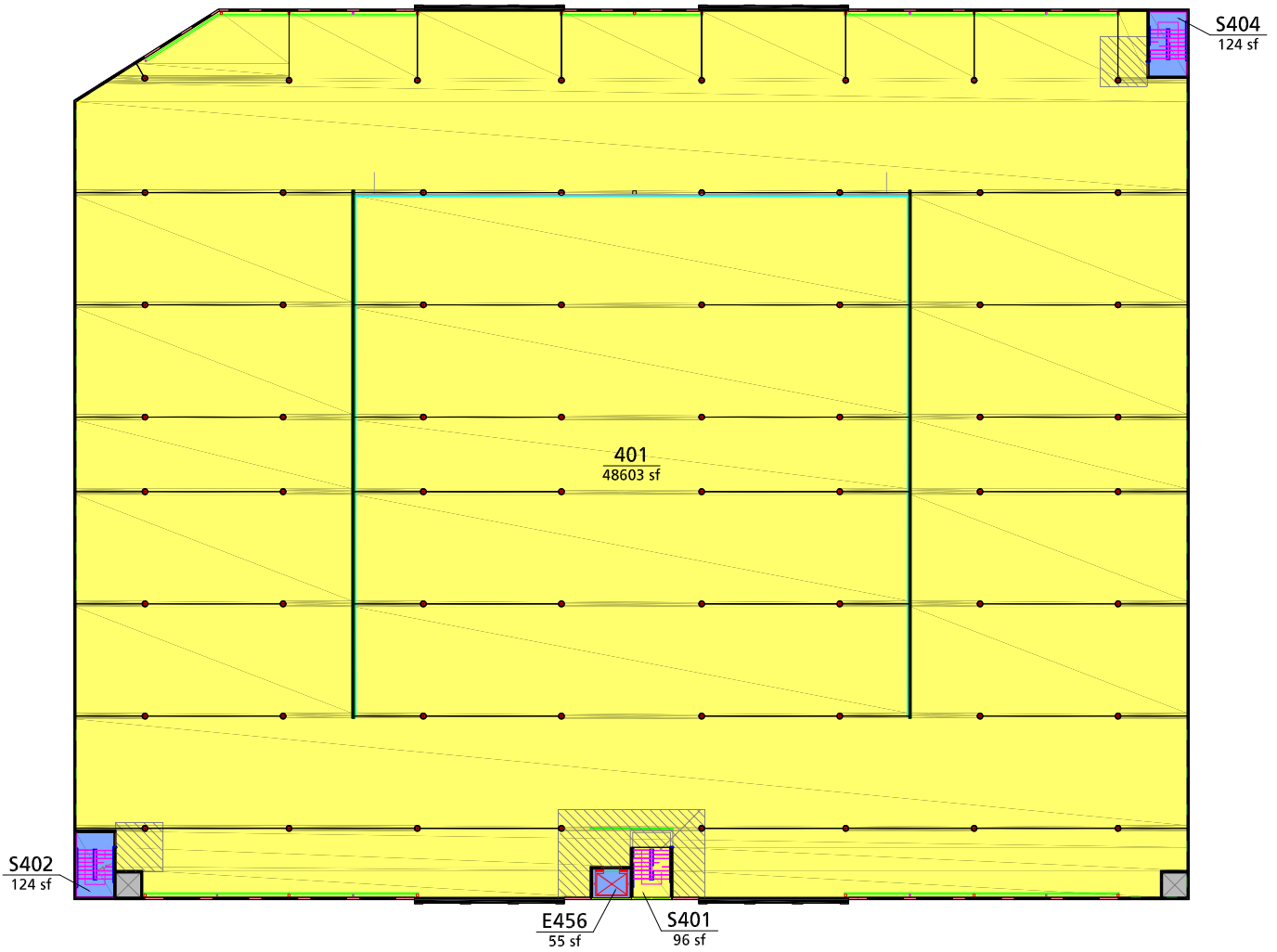

Campus Planning Office
<http://www.pdx.edu/planning-sustainability>



STANDARD LAYER REPORT

	AREA	QTY
 Circulation	303	3
 Net Assignable Space	48698	2
 Vertical Penetrations	61	2
TOTAL:	49062	7
Floor Gross:	49877	

STANDARD SPACE REPORT

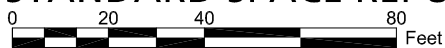

PARKING STRUCTURE THREE Fourth Floor Plan

1631 SW Twelfth Avenue, Portland, Oregon 97201

Print Date: 10/2010

Last Modified Date: 10/2010



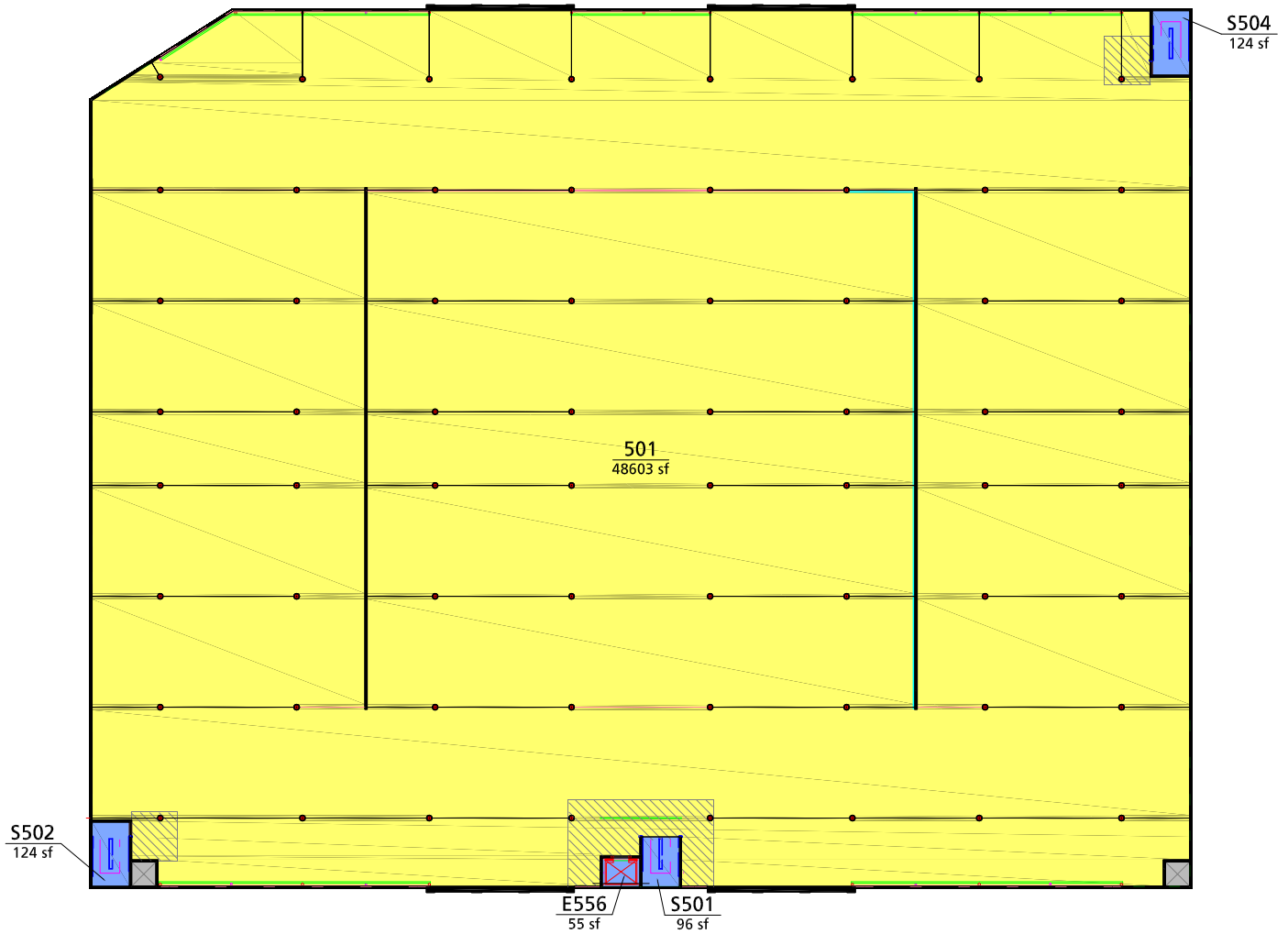

Portland State
UNIVERSITY

Capital Projects and Construction
<http://www.pdx.edu/construction>

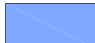

STANDARD LAYER REPORT

	AREA	QTY
 Circulation	399	4
 Net Assignable Space	48603	1
 Vertical Penetrations	61	2
TOTAL:	49063	7
Floor Gross:	49877	

STANDARD SPACE REPORT

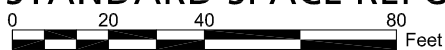

PARKING STRUCTURE THREE Fifth Floor Plan

1631 SW Twelfth Avenue, Portland, Oregon 97201

Print Date: 10/2010

Last Modified Date: 10/2010





Portland State
UNIVERSITY

Capital Projects and Construction
<http://www.pdx.edu/construction>

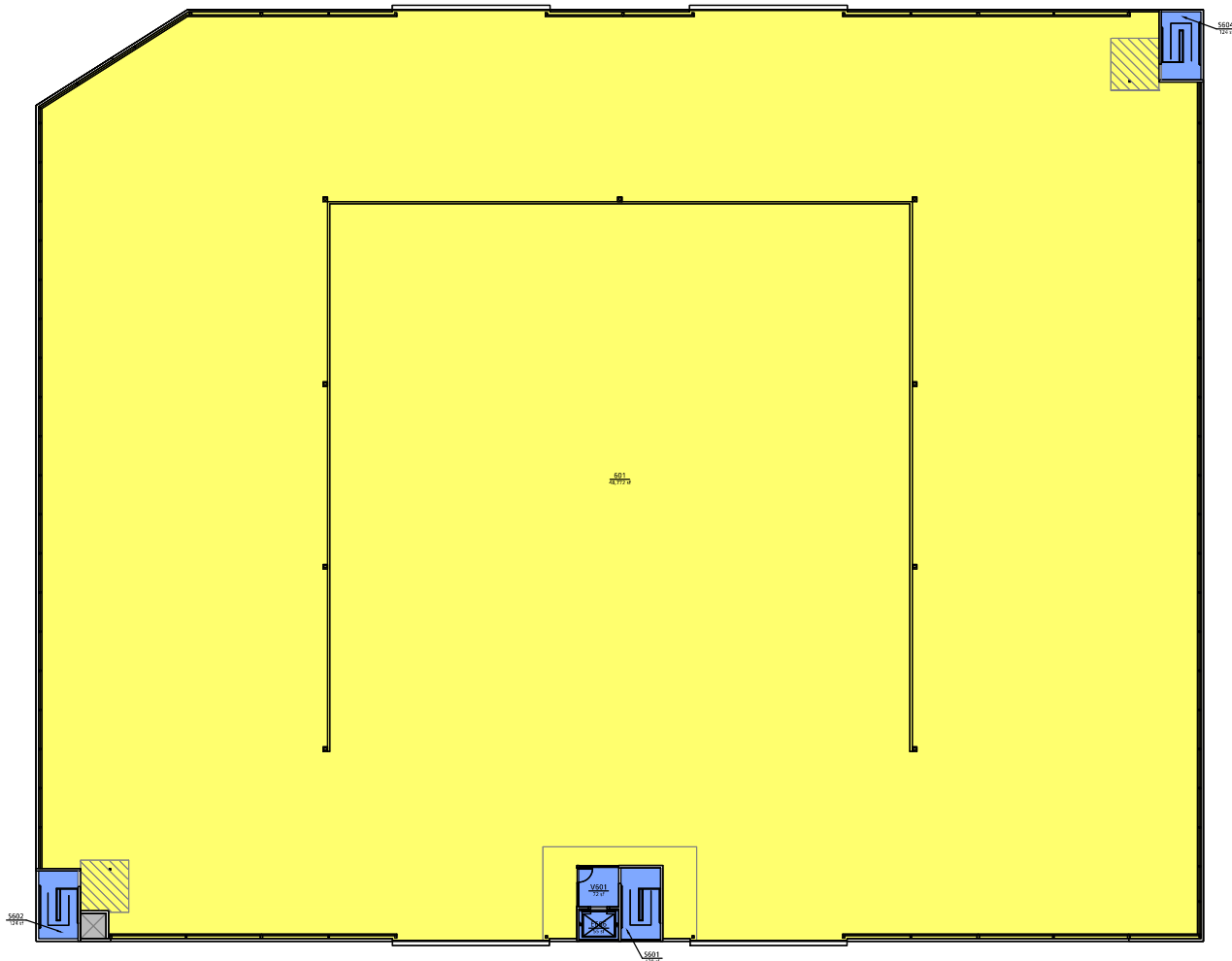
S. W. 13th AVENUE (BELOW)



S. W. 12th AVENUE (BELOW)

STANDARD LAYER REPORT			
		AREA	QTY
	Circulation	505	5
	Net Assignable Space	48,772	1
	Vertical Penetrations	30	1
	TOTAL:	49,307	7
	Floor Gross:	0	

STANDARD SPACE REPORT

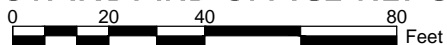

PARKING STRUCTURE THREE
 Sixth Floor Plan
 1631 SW Twelfth Avenue, Portland, Oregon 97201
 Print Date:
 Last Modified Date: 10/2018