

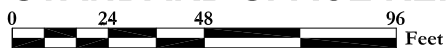

STANDARD LAYER REPORT		
	AREA	QTY
■ Building Services	218	1
■ Circulation	1,585	7
■ Mechanical Space	5,248	6
■ Net Assignable Space	74,491	4
■ Vertical Penetrations	213	3
TOTAL:	81,755	21
Floor Gross:	82,959	

STANDARD SPACE REPORT



FOURTH AVENUE BUILDING

Sub-Basement Floor Plan

1900 SW Fourth Avenue, Portland, Oregon 97201-5350

Print Date:

Last Modified Date: 06/2016



Campus Planning Office
<http://www.pdx.edu/campus-planning>

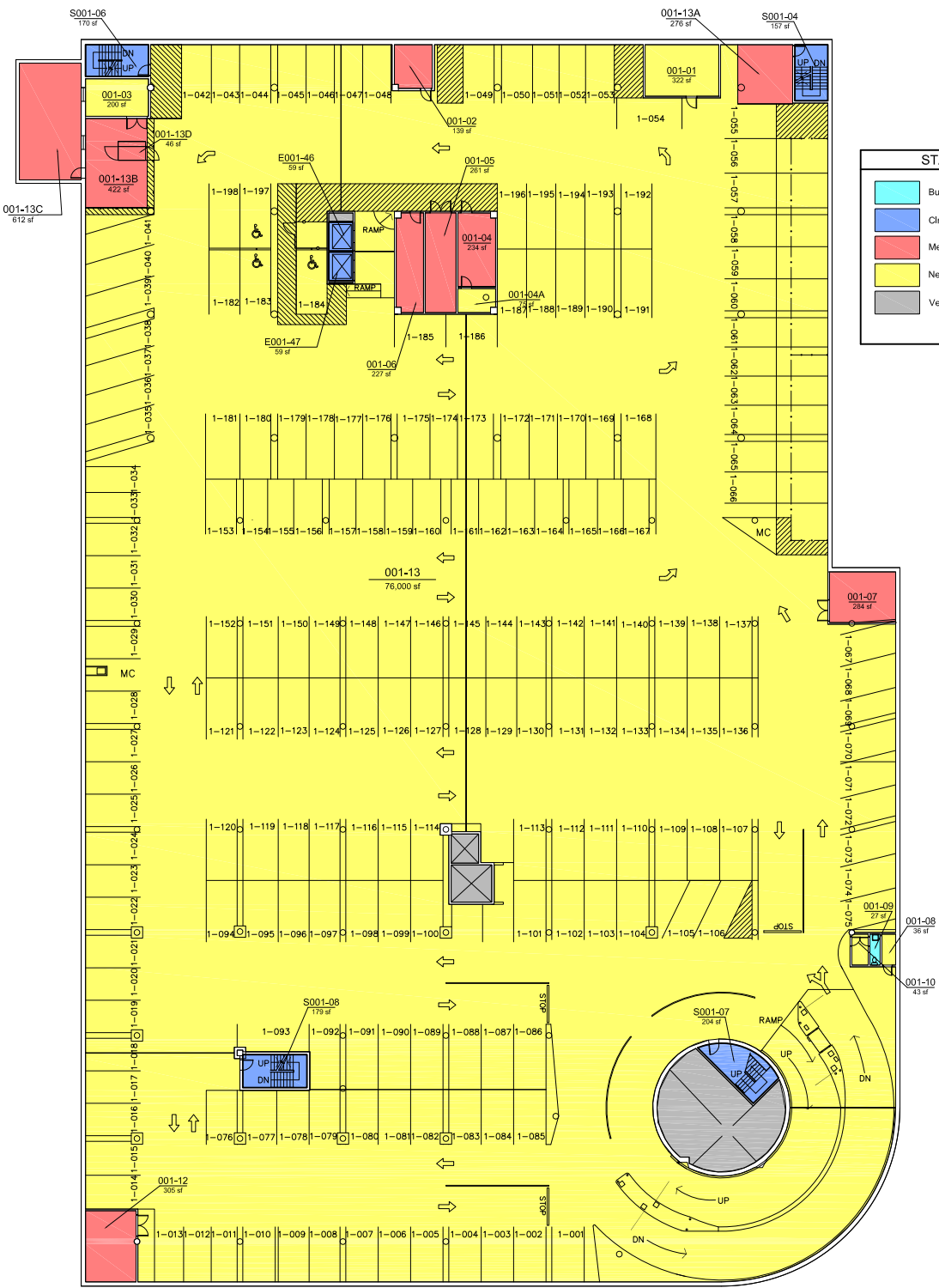

STANDARD LAYER REPORT		
	AREA	QTY
 Building Services	27	1
 Circulation	828	6
 Mechanical Space	2,806	10
 Net Assignable Space	76,676	6
 Vertical Penetrations	1,082	4
TOTAL:	81,419	27
Floor Gross:	83,643	

STANDARD SPACE REPORT

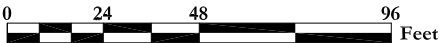

FOURTH AVENUE BUILDING

Basement Floor Plan B1

1900 SW Fourth Avenue, Portland, Oregon 97201-5350

Print Date:

Last Modified Date: 6/2016



Campus Planning Office
<http://www.pdx.edu/campus-planning>

STANDARD LAYER REPORT	
AREA	QTY
Building Services	2,381 13
Circulation	23,795 72
Mechanical Space	16,546 40
Net Assignable Space	65,632 170
Open To Below	1,656 4
Vertical Penetrations	901 22
TOTAL:	110,911 321
Floor Gross:	117,876

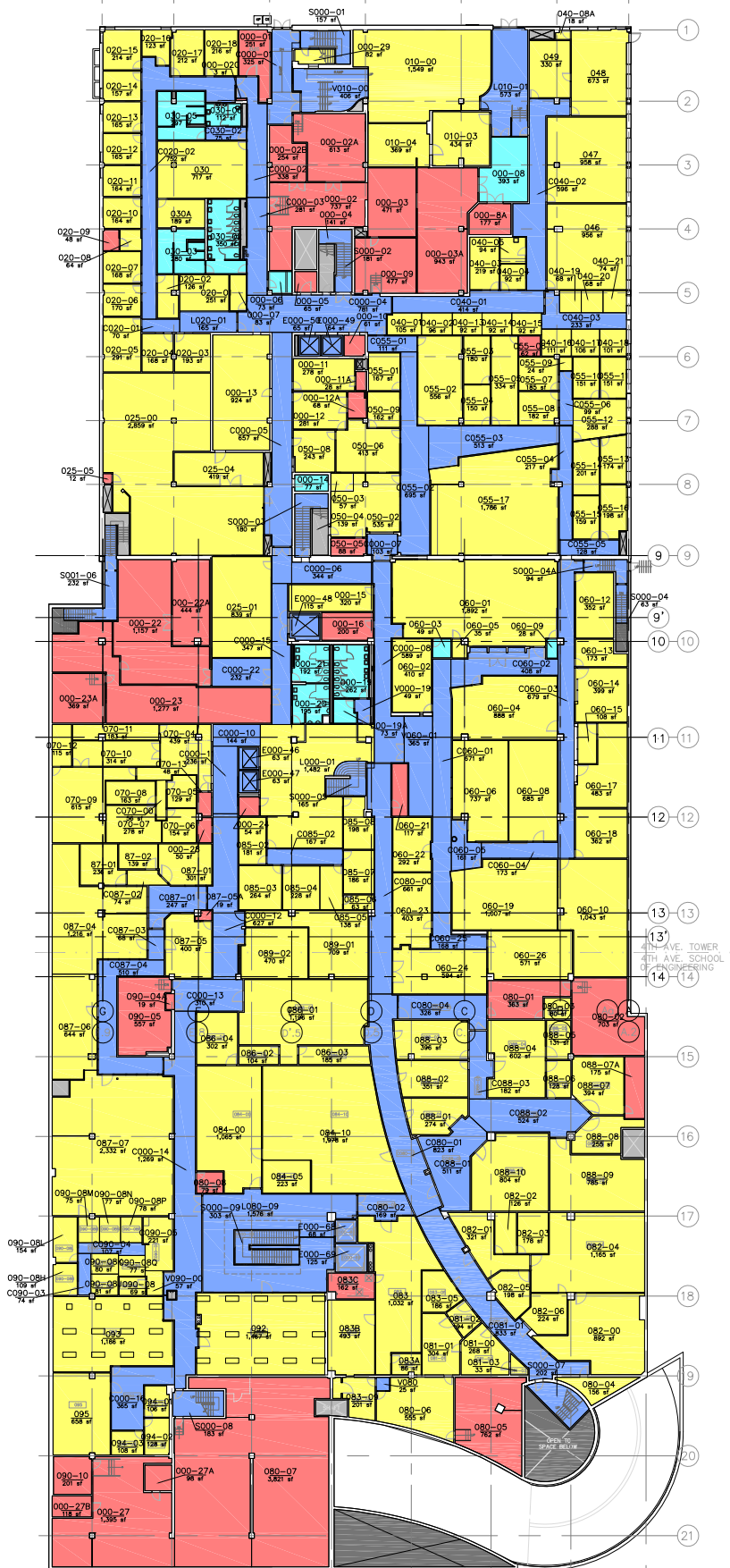

STANDARD SPACE REPORT



FOURTH AVENUE BUILDING

Lower Level Floor Plan





1900 SW Fourth Avenue, Portland, Oregon 97201-5350

Print Date:

Last Modified Date: 09/2023



Capital Projects & Construction
<http://www.pdx.edu/construction>

STANDARD LAYER REPORT		
	AREA	QTY
	Building Services	594 4
	Circulation Space	18,613 36
	Mechanical Space	1,500 5
	Net Assignable Space	23,878 125
	Vertical Penetrations	225 15
TOTAL:		44,810 185
Floor Gross:		48,427



STANDARD SPACE REPORT



FOURTH AVENUE BUILDING

Plaza Level Floor Plan

1900 SW Fourth Avenue, Portland, Oregon 97201-5350





Print Date:

Last Modified Date: 12/2022



Campus Planning Office

<http://www.pdx.edu/campus-planning>

STANDARD LAYER REPORT		
	AREA	QTY
	Building Services	709 6
	Circulation	12,918 39
	Mechanical Space	1,655 7
	Net Assignable Space	21,266 152
	Vertical Penetrations	223 29
TOTAL:		36,771 233
Floor Gross:		40,050



STANDARD SPACE REPORT



FOURTH AVENUE BUILDING SECOND FLOOR PLAN



1900 SW Fourth Avenue, Portland, Oregon 97201-5350

Print Date:

Last Modified Date: 06/2018



Campus Planning Office
<http://www.pdx.edu/campus-planning>

STANDARD LAYER REPORT			
	AREA	QTY	
	Circulation	234	1
	Mechanical Space	1,248	4
	Vertical Penetrations	62	3
TOTAL:		1,544	8
Floor Gross:		1,757	

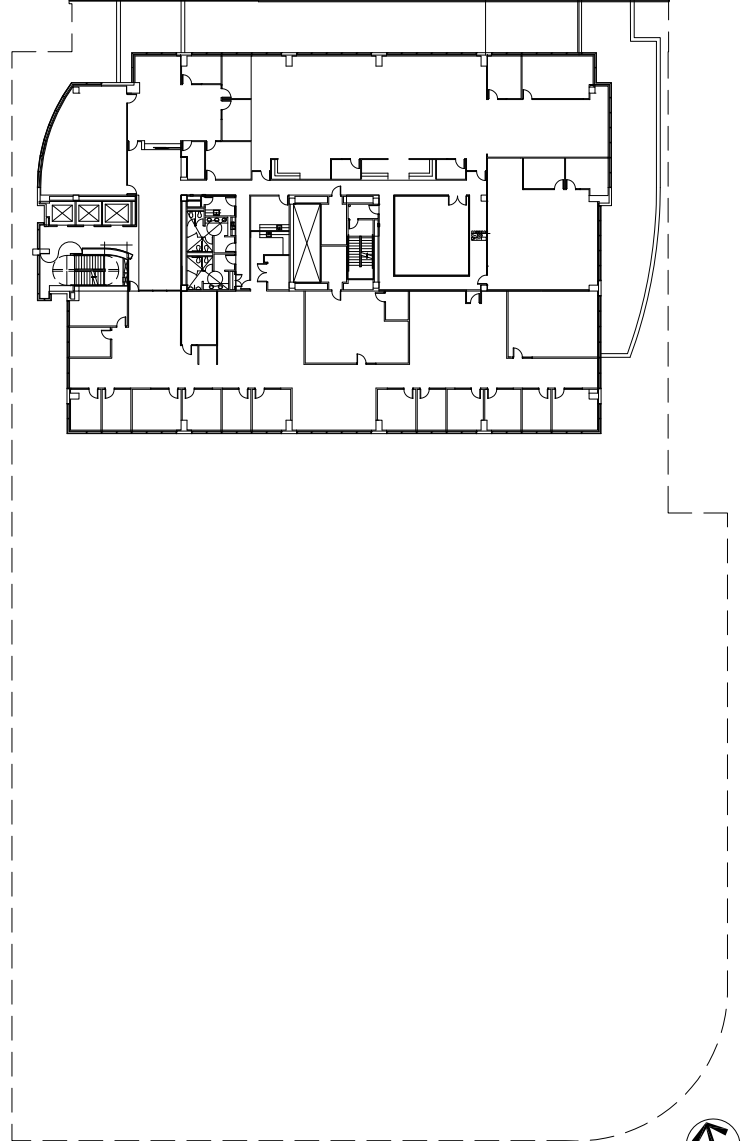
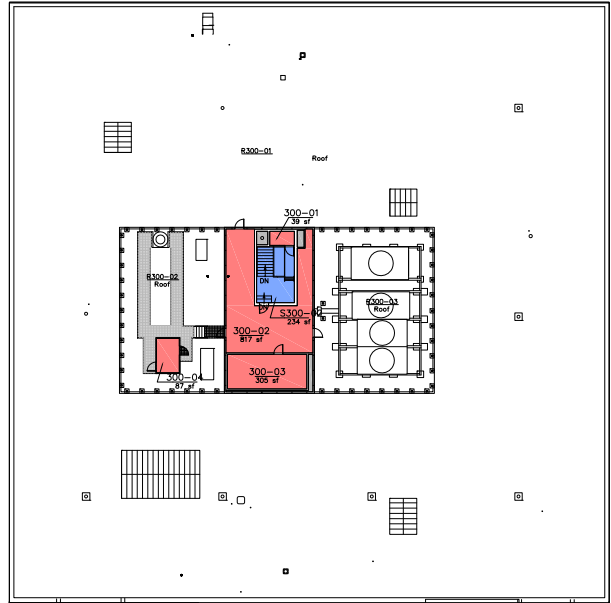

STANDARD SPACE REPORT

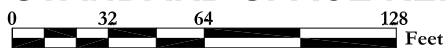

FOURTH AVENUE BUILDING PENTHOUSE FLOOR PLAN

1900 SW Fourth Avenue, Portland, Oregon 97201-5350

Print Date:

Last Modified Date: 06/2016



Campus Planning Office
<http://www.pdx.edu/campus-planning>



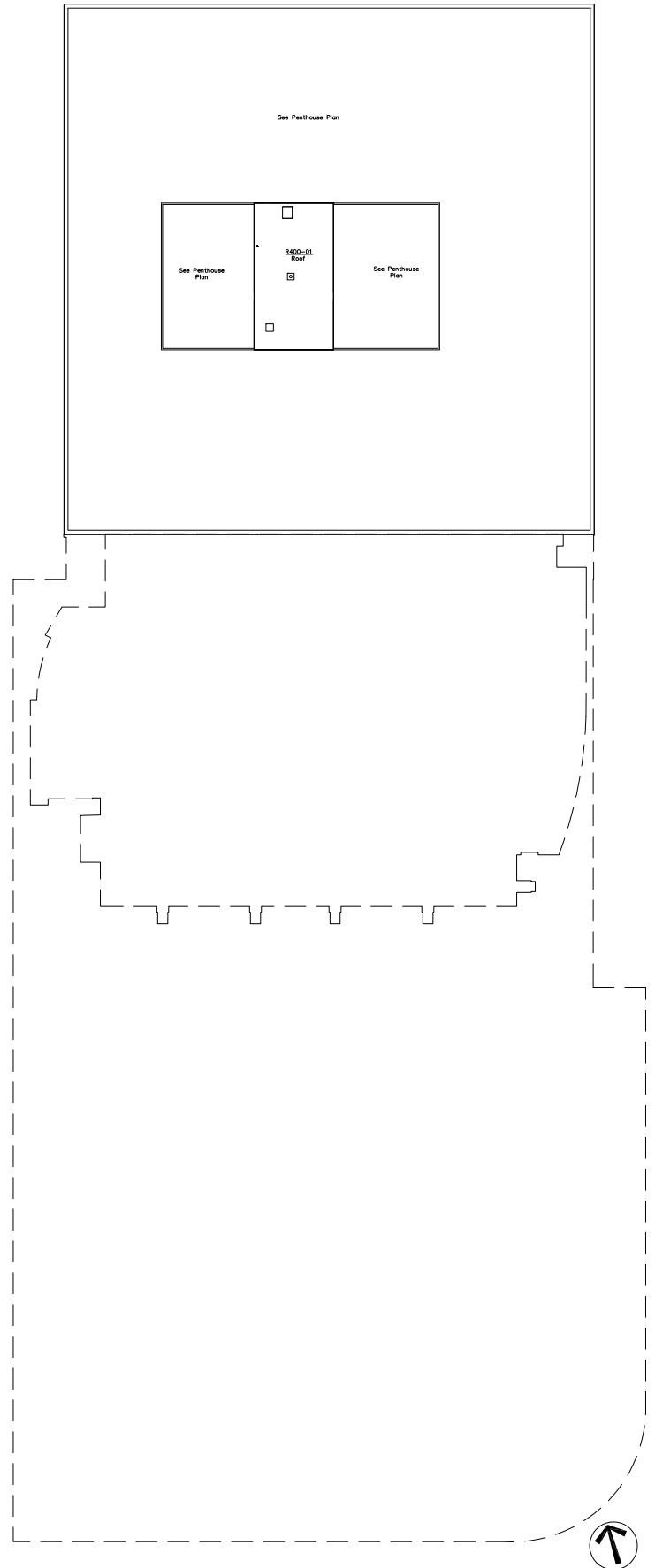

STANDARD SPACE REPORT

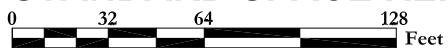

**FOURTH AVENUE BUILDING
ROOF PLAN**

1900 SW Fourth Avenue, Portland, Oregon 97201-5350
 Print Date: 2010
 Last Modified Date: 2010