

STANDARD SPACE REPORT

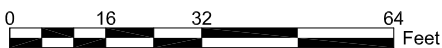

JOSEPH C. BLUMEL RESIDENCE HALL
 First Floor Plan
 1705 SW Eleventh Avenue, Portland, Oregon 97201
 Print Date:
 Last Modified Date: 05/2014

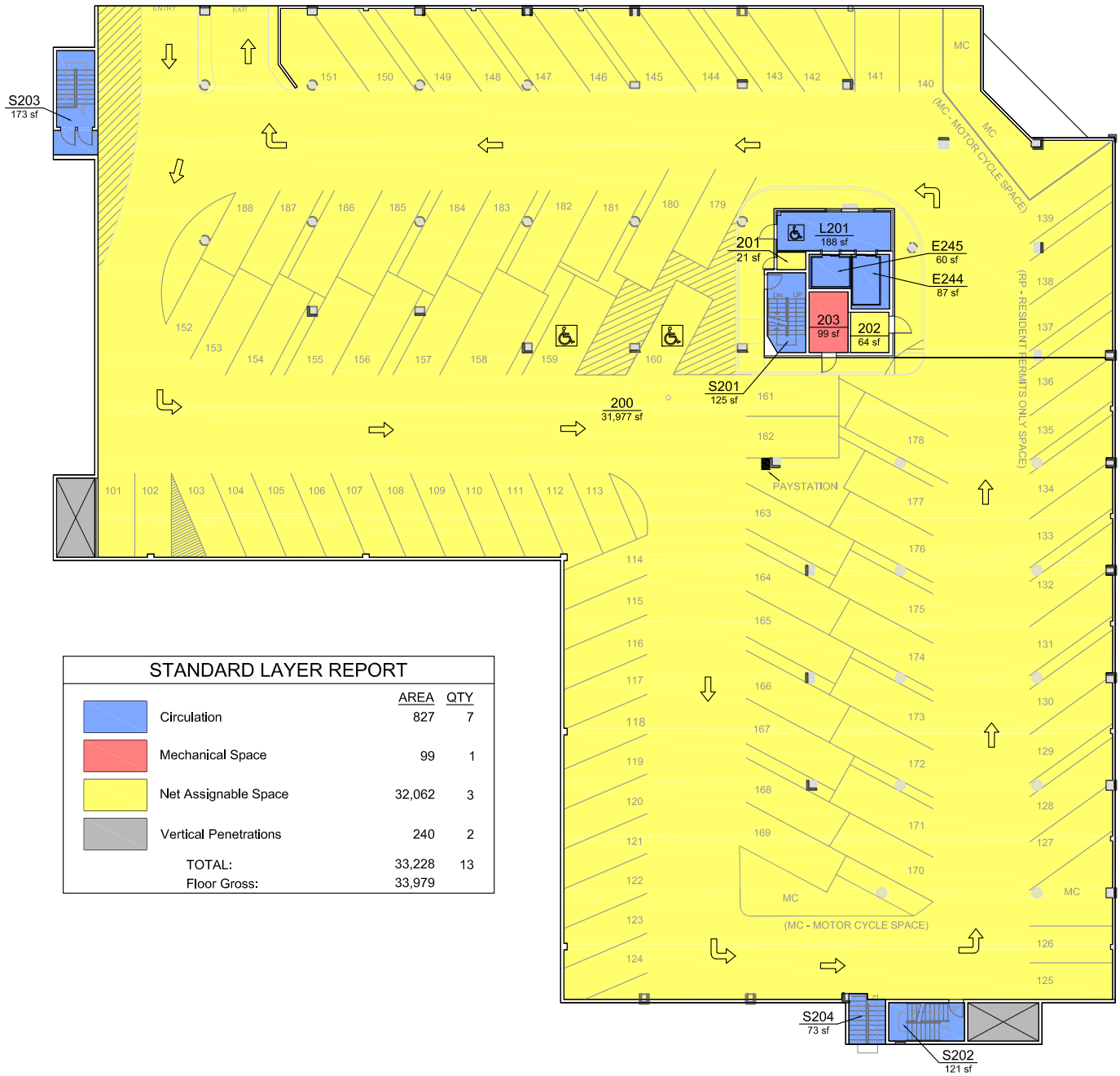

STANDARD SPACE REPORT

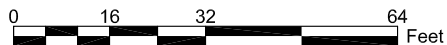

JOSEPH C. BLUMEL RESIDENCE HALL
Second Floor Plan

1705 SW Eleventh Avenue, Portland, Oregon 97201

Print Date:

Last Modified Date: 2023



Campus Planning Office

<http://www.pdx.edu/planning-sustainability>

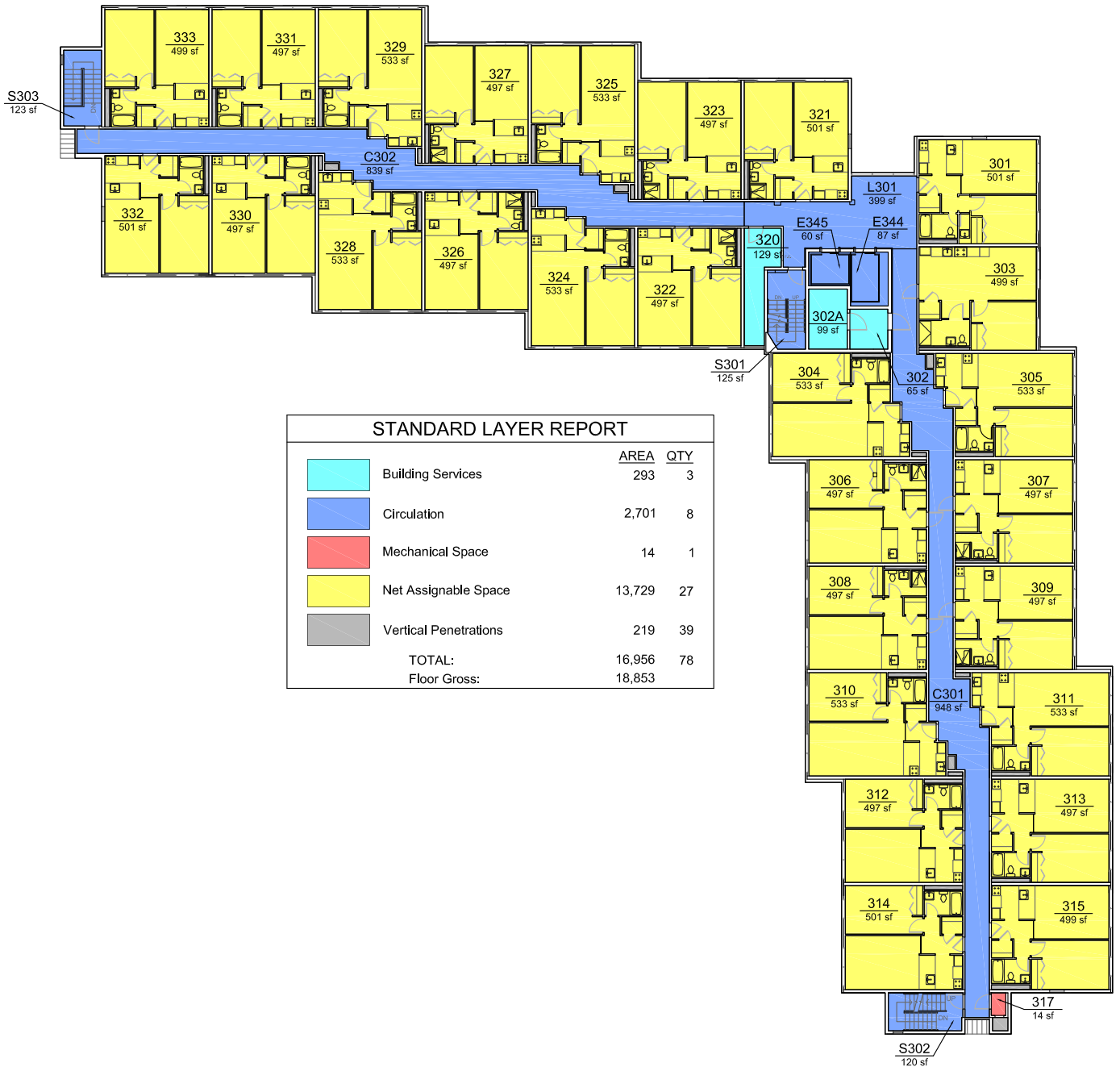

STANDARD SPACE REPORT

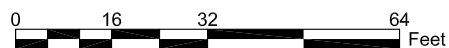

JOSEPH C. BLUMEL RESIDENCE HALL

Third Floor Plan

1705 SW Eleventh Avenue, Portland, Oregon 97201

Print Date:

Last Modified Date: 2023

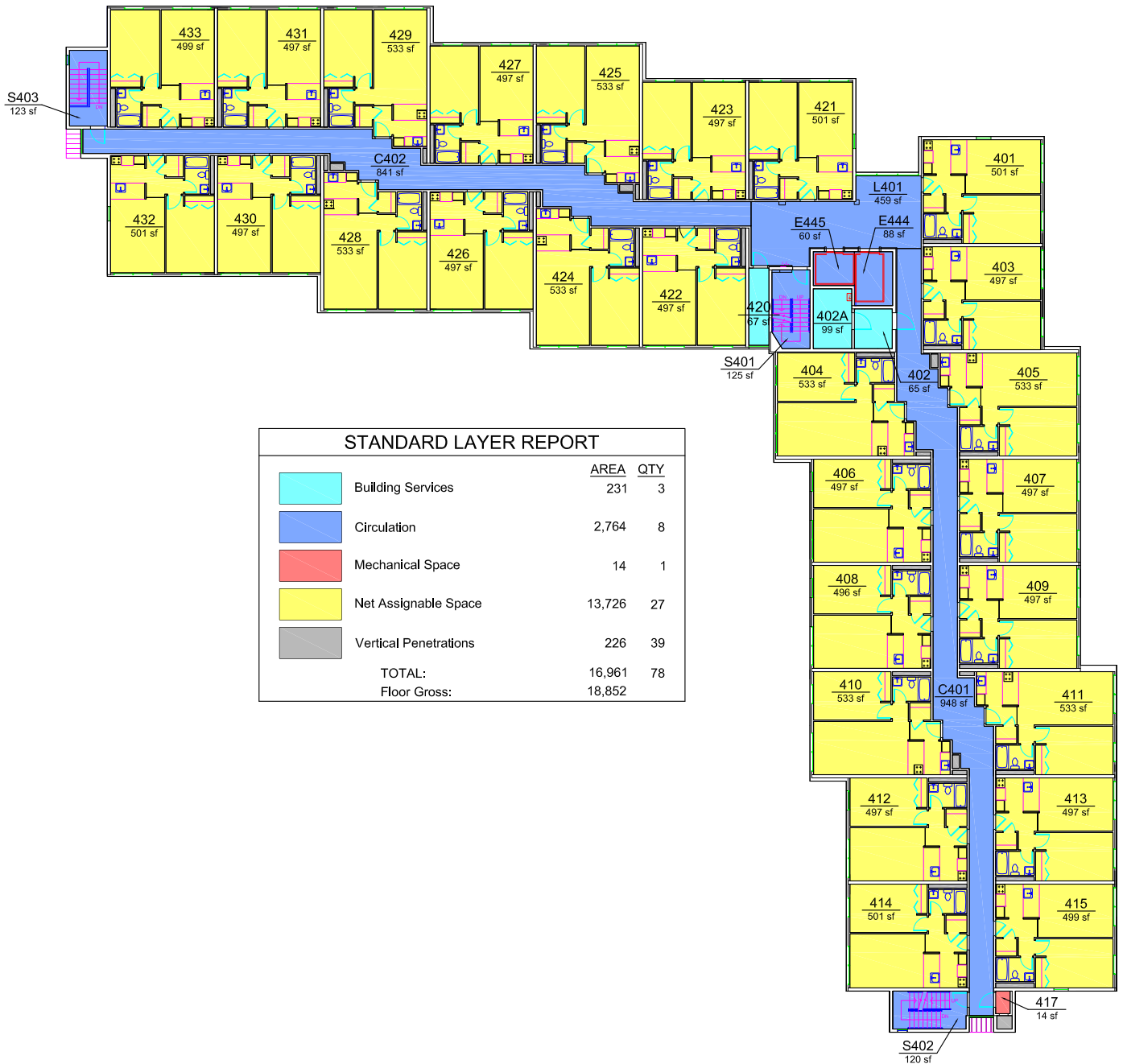

STANDARD SPACE REPORT

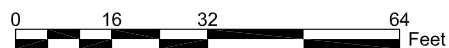

JOSEPH C. BLUMEL RESIDENCE HALL
Fourth Floor Plan

1705 SW Eleventh Avenue, Portland, Oregon 97201

Print Date:

Last Modified Date: 2023



Campus Planning Office
<http://www.pdx.edu/planning-sustainability>

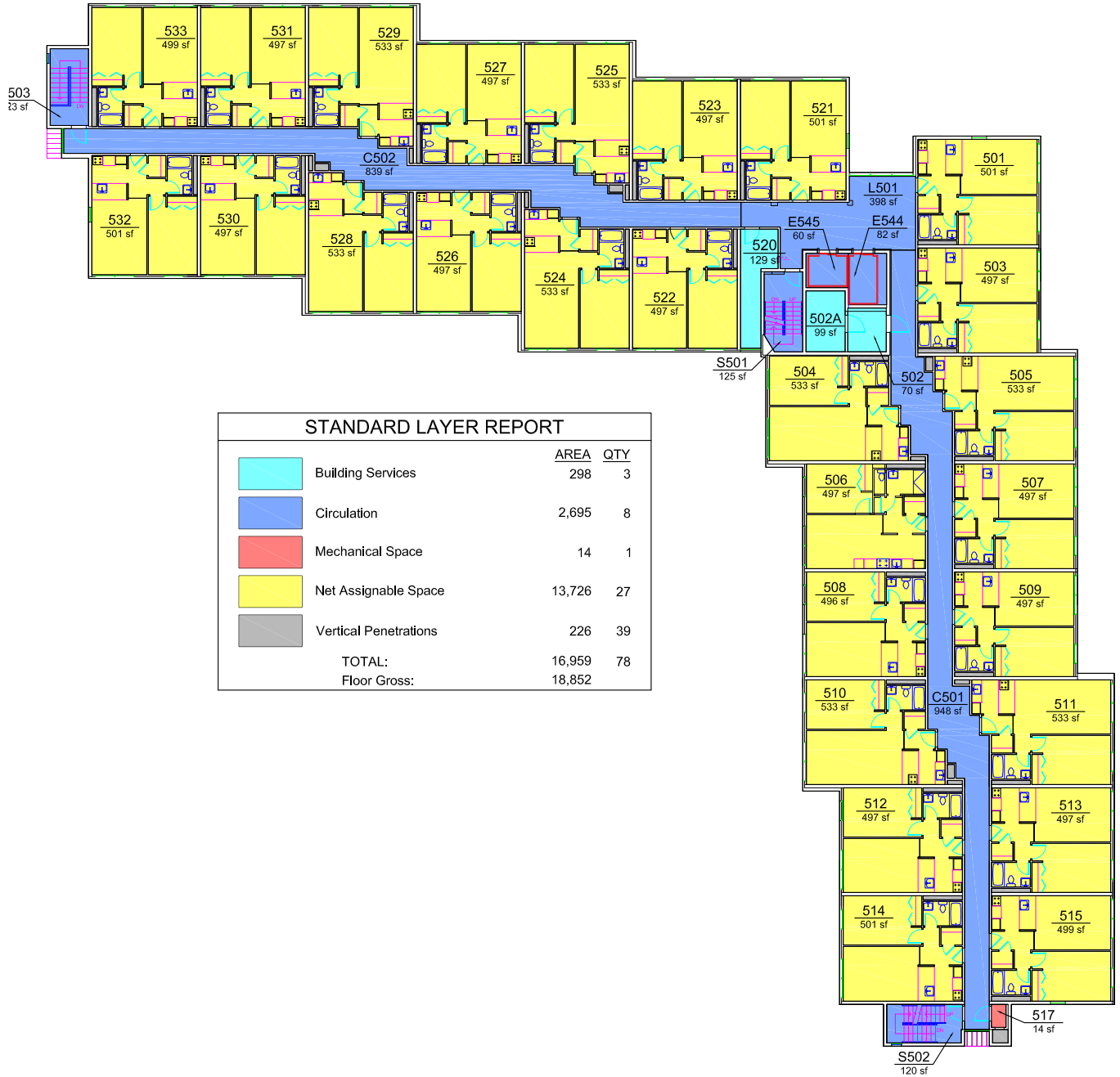

STANDARD SPACE REPORT

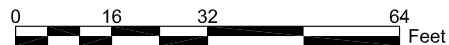

JOSEPH C. BLUMEL RESIDENCE HALL
Fifth Floor Plan

1705 SW Eleventh Avenue, Portland, Oregon 97201

Print Date:

Last Modified Date: 2023

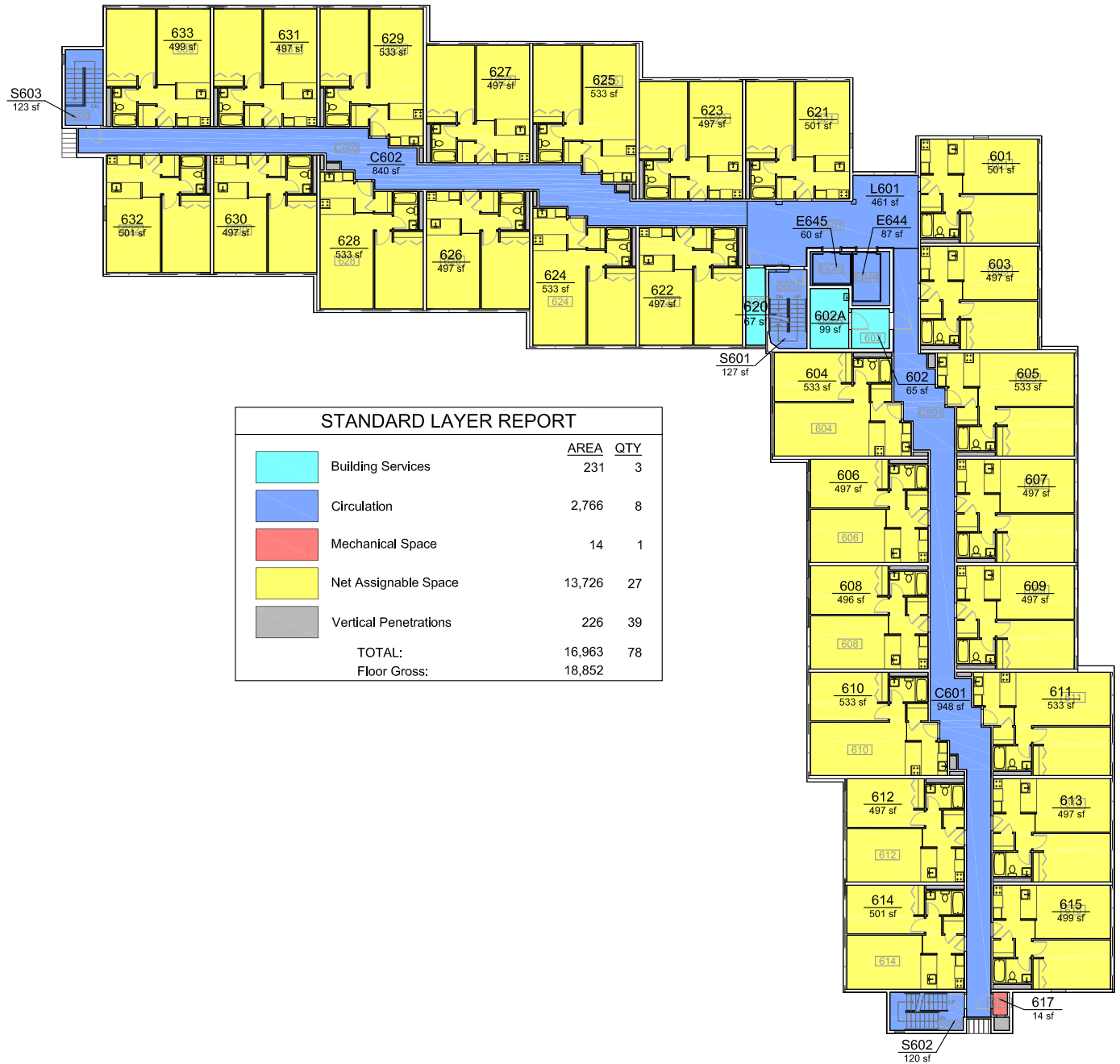

STANDARD SPACE REPORT

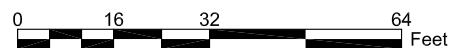

JOSEPH C. BLUMEL RESIDENCE HALL
Sixth Floor Plan

1705 SW Eleventh Avenue, Portland, Oregon 97201

Print Date:

Last Modified Date: 2023



Campus Planning Office
<http://www.pdx.edu/planning-sustainability>

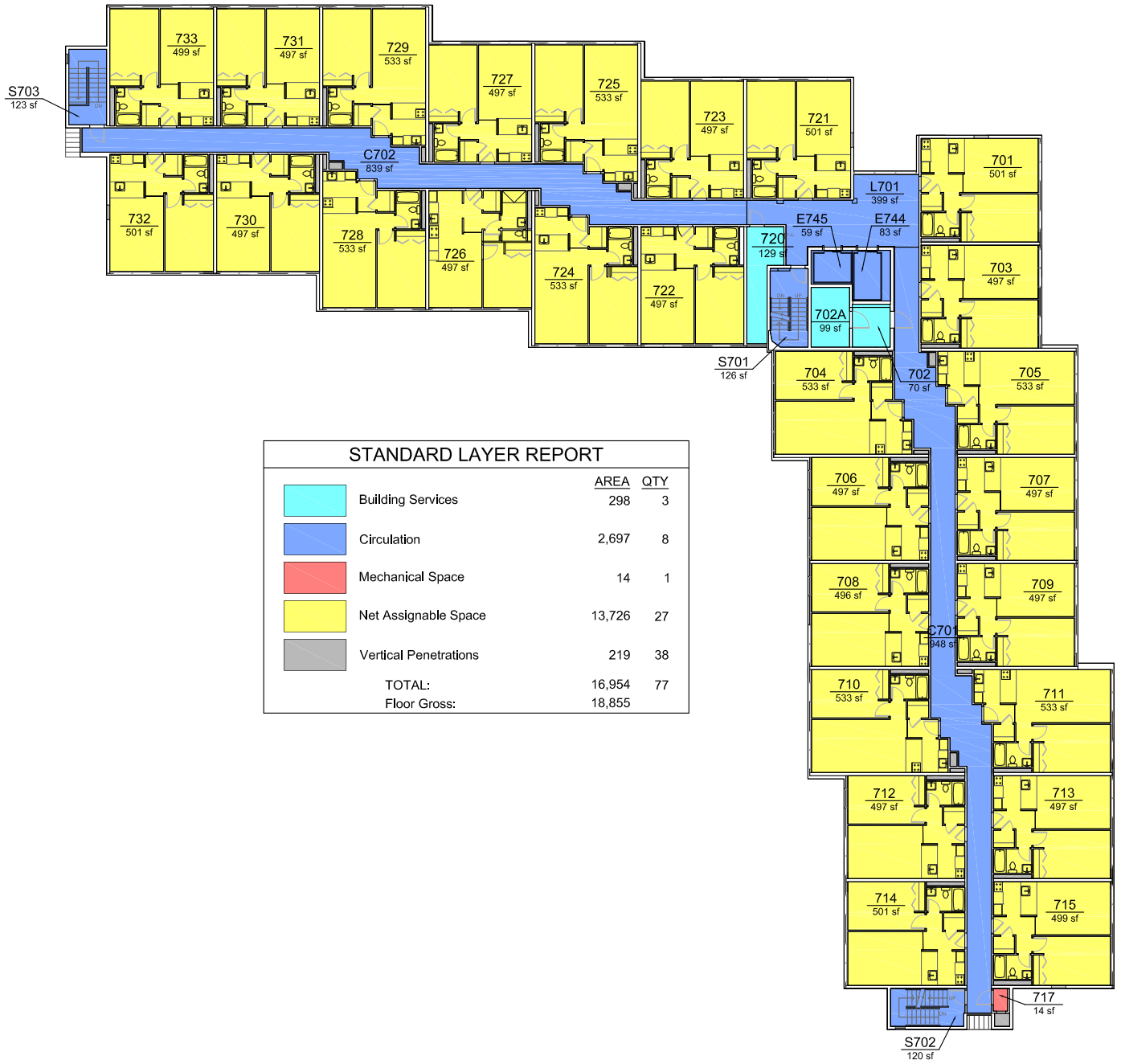

STANDARD LAYER REPORT

	AREA	QTY
 Building Services	298	3
 Circulation	2,697	8
 Mechanical Space	14	1
 Net Assignable Space	13,726	27
 Vertical Penetrations	219	38
TOTAL:	16,954	77
Floor Gross:	18,855	

STANDARD SPACE REPORT

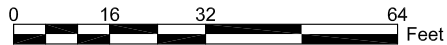

JOSEPH C. BLUMEL RESIDENCE HALL
Seventh Floor Plan

1705 SW Eleventh Avenue, Portland, Oregon 97201





Print Date:

Last Modified Date: 2023

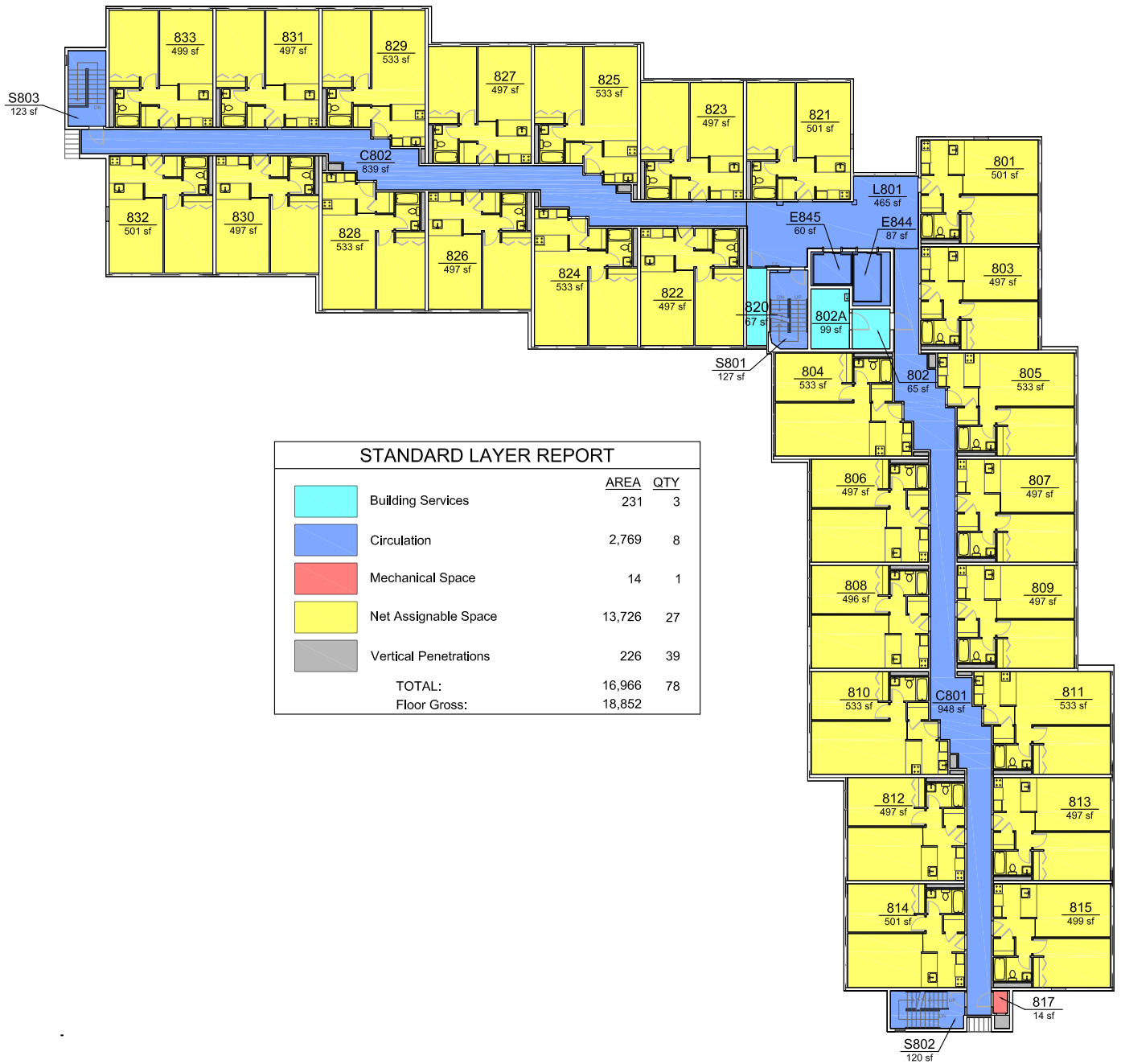

Campus Planning Office
<http://www.pdx.edu/planning-sustainability>



STANDARD LAYER REPORT		
	AREA	QTY
	Building Services	231 3
	Circulation	2,769 8
	Mechanical Space	14 1
	Net Assignable Space	13,726 27
	Vertical Penetrations	226 39
TOTAL:		16,966 78
Floor Gross:		18,852

STANDARD SPACE REPORT

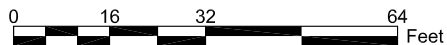

JOSEPH C. BLUMEL RESIDENCE HALL
Eighth Floor Plan

1705 SW Eleventh Avenue, Portland, Oregon 97201

Print Date:

Last Modified Date: 2023



Campus Planning Office
<http://www.pdx.edu/planning-sustainability>

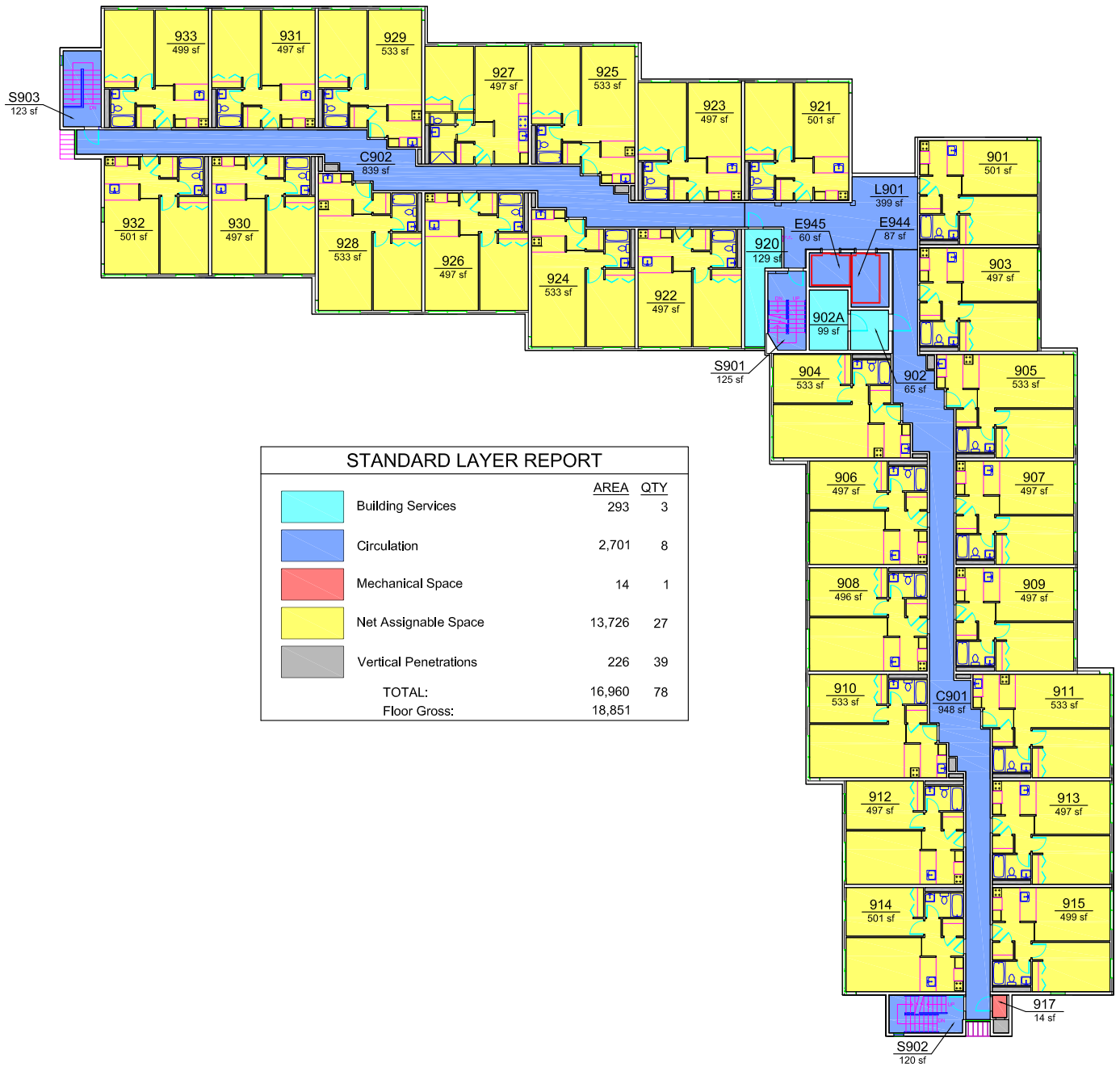

STANDARD SPACE REPORT

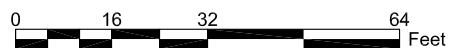

JOSEPH C. BLUMEL RESIDENCE HALL
Ninth Floor Plan

1705 SW Eleventh Avenue, Portland, Oregon 97201



Print Date:

Last Modified Date: 2023

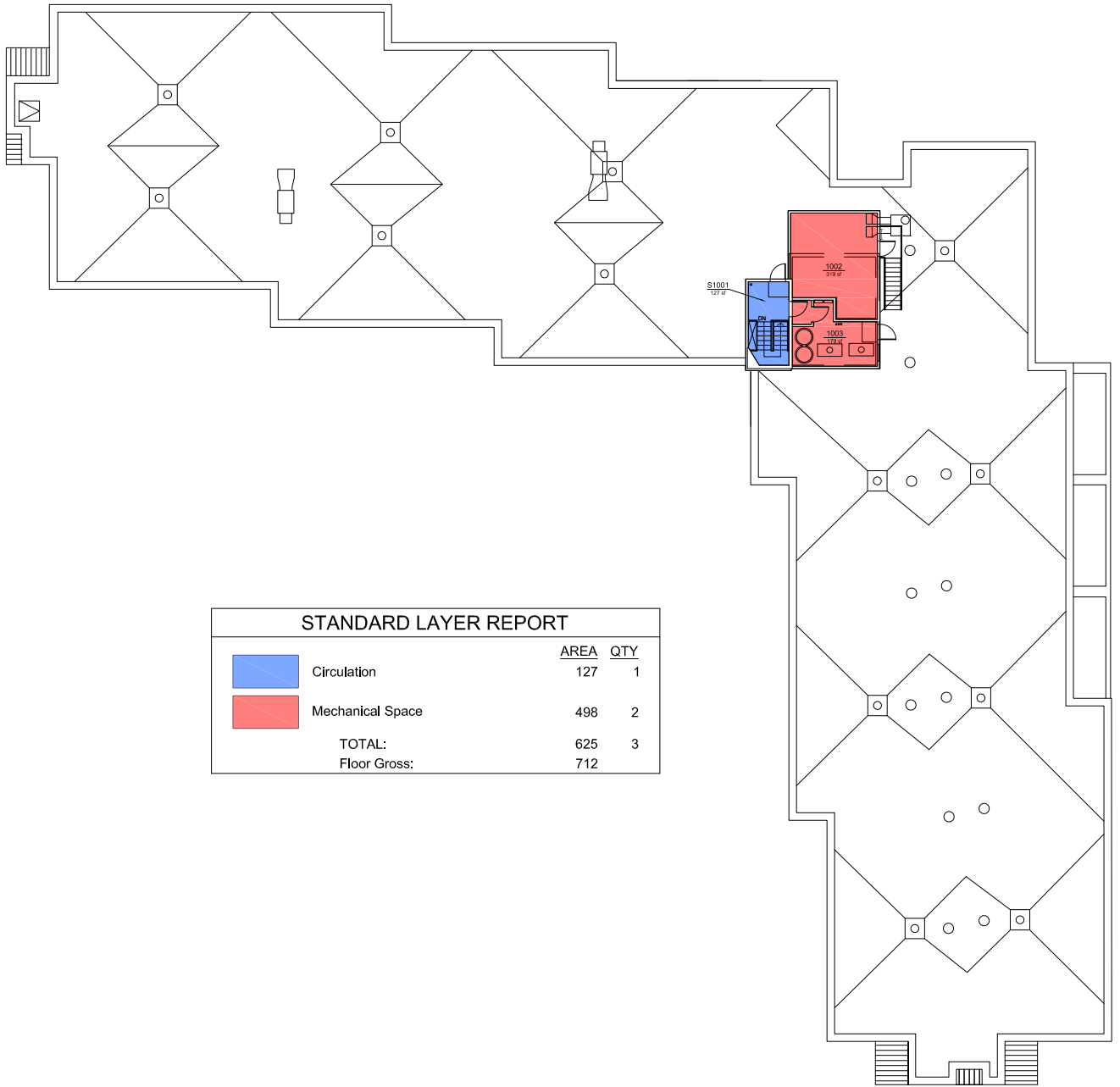

Campus Planning Office
<http://www.pdx.edu/planning-sustainability>



STANDARD LAYER REPORT		
	AREA	QTY
 Circulation	127	1
 Mechanical Space	498	2
TOTAL:	625	3
Floor Gross:	712	

STANDARD SPACE REPORT

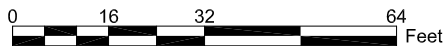

JOSEPH C. BLUMEL RESIDENCE HALL

Penthouse Plan

1705 SW Eleventh Avenue, Portland, Oregon 97201

Print Date:

Last Modified Date: 6/2013



Campus Planning Office
<http://www.pdx.edu/planning-sustainability>



STANDARD SPACE REPORT

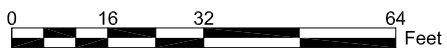

JOSEPH C. BLUMEL RESIDENCE HALL

Roof Plan

1705 SW Eleventh Avenue, Portland, Oregon 97201

Print Date: 2011

Last Modified Date: 10/2011



Campus Planning Office
<http://www.pdx.edu/planning-sustainability>